



Tel: 01656 776222 Fax: 01656 776220  
Email: ordersuk@invacare.com  
Online Spares available at www.invacare.co.uk

JANUARY 2019

Customer Ref:	Account No:
Contact No:	Order No:
Delivery Address:	Order Qty:
	Order Date:

**Invacare® Action<sup>3</sup> NG Light**  
RETAIL  
Max User Weight 125Kg (19.7 stone)

**Standard Features**

- Self Propulsion with 24" lightweight black Q/R rear wheels
- 8" x 1.1/4" castors, black non marking
- Choice of 6 Seat Widths 380mm to 505mm (15" - 20")
- Choice of 2 Seat Depths 400mm or 450mm (16" or 18")
- Choice of 6 Seat Heights 385mm to 510mm (15" - 20")
- Nylon Upholstery
- Folding 7° 430mm Backrest
- Lumbar Support Padded Backrest with Shaped Cover
- 80° Swing In/Swing Out Legrest Hangers
- Flip Up Footplates
- Swing away desk armrests
- Choice of 8 Standard Colours (with 7 Special Colours)
- Push or Pull to Lock Brakes (configuration dependant)
- Transportation Kit and Buckle Belt
- Adjustable heel straps
- User tool kit



Action<sup>3</sup> NG Light

**From 13 kg!**



**CUSTOMISE COLOUR**  
(SEE OPTION 0991)

\* Configurations may vary to the image shown

**Standard Base Price: £616**

	X	Please make your selection with a cross in the box ◆ Standard feature ○ Free of charge (NC:9999) Non-compatibilities		
→		Customer weight =		Kg
Code		Description	NC's (Non Conformance)	RETAIL
<b>MODEL</b>				
CES0017	X	ACTION <sup>3</sup> NG Light		£616
CESSPEC		ACTION 3NG Light Special Basic Model - PLEASE COMPLETE DETAILS AT THE END OF THE FORM		
<b>PROPULSION TYPE</b>				
CES0100	X	SELF PROPULSION	(NC : 1125)	◆
<b>SEAT</b>				
<b>SEAT WIDTH</b>				
		330MM SEAT WIDTH (13") (lapbelt adjustment 420mm - 1520mm) SELECT SEAT WIDTH OPTION CES0180 + IN-RIGGED ARMREST OPTION CES0952		£36
CES0180		380 MM SEAT WIDTH (15") (lapbelt adjustment 420mm - 1520mm)		○
CES0190		405 MM SEAT WIDTH (16") (lapbelt adjustment 420mm - 1520mm)		○
CES0200		430 MM SEAT WIDTH (17") (lapbelt adjustment 420mm - 1520mm)		◆
CES0210		455 MM SEAT WIDTH (18") (lapbelt adjustment 420mm - 1880mm)		○
CES0220		480 MM SEAT WIDTH (19") (lapbelt adjustment 420mm - 1880mm)		○
CES0230		505 MM SEAT WIDTH (20") (lapbelt adjustment 420mm - 1880mm)		○
<b>SEAT DEPTH</b>				
CES0240		400MM SEAT DEPTH (16")	(NC : 0879)	○
CES0250		450MM SEAT DEPTH (18")	(NC : 0878)	◆
CES0252		400 TO 450MM ADJUSTABLE SEAT DEPTH (Set at 17")	(NC : 0330, 0350)	£17

Order No :

Customer Ref :

<b>SEAT HEIGHT</b>			
CES0260	510MM SEAT HEIGHT (20")	(NC : 0511, 0561, 0738, 1049, 1050, 1051, 1052, 1117)	○
CES0270	485MM SEAT HEIGHT (19")	(NC: 0511, 0561, 1051)	○
CES0280	460MM SEAT HEIGHT (18")		◆
CES0290	435MM SEAT HEIGHT (17")	(NC : 1010, 1030, 1125)	○
CES0300	410MM SEAT HEIGHT (16")	(NC : 0935, 1010, 1030, 1052, 1125, 1370, 1440, 1441)	○
CES0310	385MM SEAT HEIGHT (15")	(NC : 0511, 0561, 0660, 0670, 0738, 0760, 0770, 0838, 0935, 1010, 1030, 1049, 1050, 1052, 1114, 1118, 1119, 1125, 1280, 1370, 1440, 1441)	○
<b>SEAT UPHOLSTERY TYPE</b>			
CES0330	NYLON WITHOUT HOOK AND LOOP STRIPS SEAT UPHOLSTERY		◆
CES0340	NYLON WITH HOOK AND LOOP STRIPS SEAT UPHOLSTERY		○
CES0350	PADDED NYLON SEAT UPHOLSTERY		£26
<b>BACKREST</b>			
<b>BACKREST TYPE</b>			
CES0380	FIXED 0° BACKREST 2 HEIGHTS 400/430MM (DELIVERED. 430MM) FIXED PUSH HANDLES	(NC : 0471, 0477, 0945, SWO0001)	○
CES0390	FIXED 0° BACKREST 510MM HEIGHT FIXED PUSH HANDLES	(NC : 0471, 0477, 0945, SWO0001)	○
CES0395	FIXED 7° BACKREST HEIGHT ADJUST 380 TO 460MM (DELIVERED 380MM) FIXED PUSH HANDLES (follow upholstery height)	(NC : 0474, 0477, 0478, 0481, 0905, 0906, 0907, 0940, SWO0001)	£51
CES0396	FIXED 7° BACKREST HEIGHT ADJUST 380 TO 460MM (DELIVERED 380MM) HEIGHT ADJUSTABLE PUSH HANDLES (independently from upholstery height)	(NC : 0474, 0477, 0478, 0481, 0905, 0906, 0907, 0940, SWO0001)	£63
CES0410	FIXED 7° BACKREST 2 HEIGHTS 400/430MM (DELIVERED. 430MM) FIXED PUSH HANDLES	(NC : 0471, 0477, 0945)	◆
CES0420	FIXED 7° BACKREST 510MM HEIGHT FIXED PUSH HANDLES	(NC : 0471, 0477, 0945)	○
CES0425	FIXED 7° BACKREST 430MM HEIGHT HEIGHT ADJUSTABLE PUSHHANDLE (150MM)	(NC : 0471, 0477, 0945, SWO0001)	£37
CES0428	FIXED 7° BACKREST ACTIVE 350MM HEIGHT (ADJUSTABLE TO 400MM) FIXED PUSH HANDLES	(NC: 0471, 0477, 0481, 0905, 0906, 0907, 0940, SWO0001, 1280)	○
CES0432	ANGLE ADJUSTABLE AND FOLD DOWN (-15° TO +15°) FIXED 7°, HEIGHT 425MM/17" WITH FIXED LONG PUSH HANDLES	(NC: 0465, 0471, 0474, 0478, 0481, 0882)	£75
CES0455	FOLDING BACKREST 430MM HEIGHT FIXED PUSH HANDLES	(NC : 0471, 0477, 0945)	£53
CES0460	FOLDING BACKREST 510MM HEIGHT FIXED PUSH HANDLES	(NC : 0471, 0477, 0481, 0945)	£53
<b>BACKREST UPHOLSTERY TYPE</b>			
CES0465	WITHOUT BACKREST UPHOLSTERY	(NC: 0882)	○
CES0471	BASIC NYLON SLING TYPE (JEMIMA)	(NC: 0882, 0905, 0906, 0907)	○
CES0474	LUMBAR SUPPORT (+1 STRAP) BI MATERIAL PADDED COVER INCL. BACK POCKET		○
CES0477	CONTOUR ADJUSTABLE (3+1 STRAPS) BI MATERIAL PADDED COVER INCL BACK POCKET		£47
CES0478	CONTOUR ADJUSTABLE (HALF TENSION ADJUSTABLE, 3+1 STRAPS) BI MATERIAL PADDED COVER INCL. BACK POCKET (INCLUDING BACKBRACE)	(NC : 0940, 0945)	£53
CES0481	CONTOUR ADJUSTABLE (FULL TENSION ADJUSTABLE, 7+1 STRAPS) BI MATERIAL PADDED COVER INCL. BACK POCKET (INCLUDING BACKBRACE)	(NC : 0940, 0945)	£103
<b>HANGERS/FOOTPLATES</b>			
<b>HANGERS RH TYPE</b>			
CES0510	80° STRAIGHT RH SWING IN/SWING OUT HANGER	(NC 0931, 0933, 0934)	◆
CES0511	90° STRAIGHT RH SWING IN/SWING OUT HANGER (ONLY AVAILABLE IN BLACK)	(NC: 0600, 0931, 0933, 0934, 0936, 1010, 1030, 1049, 1050, 1052)	○
CES0520	ELEVATING LEGREST (0° TO 80°) RH SWING IN/SWING OUT HANGER (INCLUDING CALFPAD)	(NC : 0611, 0930, 0936)	£90
CES0545	AMPUTEE LEGREST RH	(NC : 0600, 0610, 0611, 0930, 0931, 0933, 0934, 0936)	£114
<b>HANGERS LH TYPE</b>			
CES0560	80° STRAIGHT LH SWING IN/SWING OUT HANGER	(NC : 0931, 0932, 0934)	◆
CES0561	90° STRAIGHT LH SWING IN/SWING OUT HANGER (ONLY AVAILABLE IN BLACK)	(NC: 0620, 0931, 0932, 0934, 0936, 1010, 1030, 1049, 1050, 1052)	○
CES0570	ELEVATING LEGREST (0° TO 80°) LH SWING IN/SWING OUT HANGER (INCLUDING CALFPAD)	(NC : 0611, 0930, 0936)	£90
CES0595	AMPUTEE LEGREST LH	(NC : 0611, 0620, 0630, 0930, 0931, 0932, 0934, 0936)	£114

Order No :

Customer Ref :

<b>FOOTPLATES RH TYPE</b>			
CES0600	FLIP UP RH FOOTPLATE	(NC : 0931, 0933, 0934)	◆
CES0610	FLIP UP DEPTH & ANGLE AJUSTABLE RH FOOTPLATE		£37
CES0611	ONE PIECE FOOTPLATE - DEPTH & ANGLE ADJUSTABLE	(NC: 0620, 0630, 0931, 0932, 0934, 0935, 0936)	£67
<b>FOOTPLATES LH TYPE</b>			
CES0620	FLIP UP LH FOOTPLATE	(NC : 0931, 0933, 0934)	◆
CES0630	FLIP UP DEPTH & ANGLE AJUSTABLE LH FOOTPLATE		£37
<b>ARMRESTS</b>			
<b>ARMRESTS RH FORM IN BLACK ONLY</b>			
CES0640	REMOVABLE DESK ARM RH (N°1) ADJ 200 TO 280MM HEIGHT. Autolock safety device included.	(NC : 0750, 0760, 0770, 0780, 0790, 0795, 0796, 0838, 1480, 1483)	○
CES0650	REMOVABLE FULL ARM RH (N°1) ADJ 200 TO 280MM HEIGHT. Autolock safety device included.	(NC : 0740, 0760, 0770, 0780, 0790, 0795, 0796, 0838)	○
CES0660	SWING AWAY DETACHABLE DESK ARM RH (N°2) 240MM HEIGHT	(NC : 0740, 0750, 0770, 0780, 0790, 0795, 0796, 0838, 0952, 1480, 1483)	◆
CES0670	SWING AWAY DETACHABLE FULL ARM RH (N°2) 240MM HEIGHT	(NC : 0740, 0750, 0760, 0780, 0790, 0795, 0796, 0838, 0952)	○
CES0680	SWING AWAY DETACHABLE DESK ARM RH (N°3) ADJ. IN HEIGHT	(NC : 0740, 0750, 0760, 0770, 0790, 0795, 0796, 0832, 0838, 0952, 1480, 1483)	£48
CES0690	SWING AWAY DETACHABLE FULL ARM RH (N°3) ADJ. IN HEIGHT & DEPTH	(NC : 0740, 0750, 0760, 0770, 0780, 0795, 0796, 0832, 0838, 0952, 1483)	£48
CES0695	REMOVABLE DESK ARM RH (N°4) ADJ. IN HEIGHT. Autolock safety device included.	(NC : 0740, 0750, 0760, 0770, 0780, 0790, 0796, 0838, 0952, 1480, 1483)	£51
CES0696	REMOVABLE FULL ARM RH (N°4) ADJ. IN HEIGHT & DEPTH. Autolock safety device included.	(NC : 0740, 0750, 0760, 0770, 0780, 0790, 0795, 0838, 0952, 1483)	£51
CES0732	REMOVABLE RH (N°4) ARMPAD HEMI DARTEX MULTI POSITION. Autolock safety device included.	(NC : 0780, 0790, 0795, 0796, 0838, 0952, 1480, 1483)	£50
CES0738	REMOVABLE MUDGUARD RH (N°6) (CUSHION IS RECOMMENDED FOR SEAT HEIGHT 410 & 435MM) HEIGHT ADJUSTABLE	(NC : 0740, 0750, 0760, 0770, 0780, 0790, 0795, 0796, 0832, 0952, 1051, 1116, 1117, 1200, 1201, 1480, 1483)	£30
<b>ARMRESTS LH FORM IN BLACK ONLY</b>			
CES0740	REMOVABLE DESK ARM LH (N°1) ADJ 200 TO 280MM HEIGHT. Autolock safety device included.	(NC : 1480, 1484)	○
CES0750	REMOVABLE FULL ARM LH (N°1) ADJ 200 TO 280MM HEIGHT. Autolock safety device included.		○
CES0760	SWING AWAY DETACHABLE DESK ARM LH (N°2) 240MM HEIGHT	(NC : 0952, 1480, 1484)	◆
CES0770	SWING AWAY DETACHABLE FULL ARM LH (N°2) 240MM HEIGHT	(NC: 0952)	○
CES0780	SWING AWAY DETACHABLE DESK ARM LH (N°3) ADJ. IN HEIGHT	(NC : 0952, 1480, 1484)	£48
CES0790	SWING AWAY DETACHABLE FULL ARM LH (N°3) ADJ. IN HEIGHT & DEPTH	(NC : 0952, 1484)	£48
CES0795	REMOVABLE DESK ARM LH (N°4) ADJ. IN HEIGHT. Autolock safety device included.	(NC : 0952, 1480, 1484)	£51
CES0796	REMOVABLE FULL ARM LH (N°4) ADJ IN HEIGHT & DEPTH. Autolock safety device included.	(NC : 0952, 1484)	£51
CES0832	REMOVABLE LH (N°4) ARMPAD HEMI DARTEX MULTI POSITION. Autolock safety device included.	(NC : 0952, 1480, 1484)	£50
CES0838	REMOVABLE MUDGUARD LH (N°6) (CUSHION IS RECOMMENDED FOR SEAT HEIGHT 410 & 435MM) HEIGHT ADJUSTABLE	(NC: 0952, 1051, 1116, 1117, 1200, 1201, 1480)	£30
<b>SEAT CUSHION TYPE</b>			
CES0849	BASIC 50MM FOAM CUSHION - NYLON & ANTI-SLIP COVER	(NC: 0952)	£20
<b>SEAT CUSHION DEPTH</b>			
CES0878	FOR 400MM SEAT DEPTH		○
CES0879	FOR 450MM SEAT DEPTH		○

Order No :

Customer Ref :

OTHER SEATING OPTIONS			
CES0882		LATERAL POSITIONING PADS (PAIR)	£52
CES0905		NECKREST, DARTEX (INCLUDING BACKBRACE) (NC : 0940, 0945)	£113
CES0906		HEADREST, DARTEX (INCLUDING BACKBRACE) SIDEWAYS ADJUSTABLE (NC : 0940, 0945)	£136
CES0907		HEADREST WITH CHEEK SUPPORT, DARTEX (INCLUDING BACKBRACE) SIDEWAYS ADJUSTABLE (NC : 0940, 0945)	£157
SWO0001		MULTI ADJUSTABLE SWING AWAY LATERAL SUPPORTS (PAIR). <i>IMPORTANT NOTE: THIS OPTION IS ONLY AVAILABLE AS A SPECIAL ORDER. LEAD TIME 2-3 WEEKS. ONLY AVAILABLE WITH BACKREST OPTIONS: 0410, 0420, 0455 &amp; 0460.</i>	£244
CES0930		ADJUSTABLE CALF STRAP	○
CES0935		LONGER FOOTREST TUBE (NC : 0936)	£26
CES0936		SHORTER FOOTREST SUPPORT (PAIR) FOR SHORTER KNEE TO HEEL MEASUREMENTS: (230MM - 430MM WITH 0600 & 0620, 250MM - 380MM WITH 0610 & 0630).	£36
CES0940		BACKBRACE (NC: 0945)	£30
CES0945		FOLDABLE BACKBRACE	£33
CES0952		IN-RIGGED ARMREST OPTION (SEAT WIDTH LESS 50MM) (NC : 1480, 1483, 1484)	£36
COLOURS			
CES0961		SLATE GREY	○
CES0964		PEARL WHITE	○
CES0965		ELECTRIC GREEN	○
CES0966		MATT BLACK	○
CES0967		BLUE POP	○
CES0968		HYPNOTIC PURPLE	○
CES0969		RED MATT	○
CES0980		ANTHRACITE BLACK	○
CES0991		SPECIAL RAL COLOUR - 3 WEEK LEAD TIME	£145
SWO0607		DARK RED - SPECIAL COLOUR 3 WEEK LEAD TIME	£145
SWO0515		PEARL GREY - SPECIAL COLOUR 3 WEEK LEAD TIME	£145
SWO0647		INTENSE YELLOW - SPECIAL COLOUR 3 WEEK LEAD TIME	£145
SWO0648		VIBRANT ORANGE - SPECIAL COLOUR 3 WEEK LEAD TIME	£145
SWO0651		POLAR BLUE - SPECIAL COLOUR 3 WEEK LEAD TIME	£145
SWO0652		CANDY PINK - SPECIAL COLOUR 3 WEEK LEAD TIME	£145
CASTOR HOUSING TYPE			
CES0996	X	LIGHTWEIGHT	◆
FRONT WHEELS			
CES1010		200MM x 30MM (8" x 1.1/4") BLACK SOLID TYRE	◆
CES1030		200MM x 50MM (8" x 2") BLACK SOLID TYRE	£24
CES1049		150MM x 30MM (6" x 1.1/4") GREY SOLID TYRE MEDIUM HARD	£24
CES1050		150MM x 30MM (6" x 1.1/4") BLACK SOLID TYRE	£24
CES1051		125MM x 30MM (5" x 1.1/4") GREY SOLID TYRE (NC : 1114, 1118, 1119)	£24
CES1052		140MM x 45MM (5" 1/2 x 1" 3/4) GREY SOLID TYRE MEDIUM HARD	£24
REAR WHEELS			
REAR WHEEL TYPE			
CES1114		595MM x 25MM (24" X 1.3/8") LIGHTWEIGHT BLACK SOLID TYRE RADIAL SPOKED (NC: 1201, 1261, 1280)	◆
CES1117		560MM x 25MM (22" X 1") LIGHTWEIGHT PNEUMATIC TYRE RADIAL SPOKED (NC: 1201, 1230, 1260, 1280)	○
CES1118		595MM x 25MM (24" X 1") LIGHTWEIGHT PNEUMATIC TYRE RADIAL SPOKED (NC: 1201, 1230, 1261, 1280)	○
CES1119		595MM x 25MM (24" X 1") LIGHTWEIGHT MARATHON PLUS PNEUMATIC TYRE RADIAL SPOKED (NC: 1201, 1230, 1261, 1280)	£31
CES1125		305 X 45 MM (12" x 2") BLACK SOLID TYRE PLASTIC RIM	◆

<b>HANDRIM TYPE</b>			
CES1140		ALUMINIUM PRE-ANODIZED HANDRIM	◆
CES1150		STEEL HANDRIM COATED IN BLACK ANTI-SLIP PLASTIC	£29
<b>REAR WHEELS AXLE TYPE</b>			
CES1180		QUICK RELEASE AXLE	◆
<b>REAR WHEELS POSITION</b>			
CES1190		STANDARD REAR WHEELS POSITION	◆
CES1200		PASSIVE REAR WHEELS POSITION	○
<b>PUMP</b>			
CES1230		PUMP AND SUPPORT	£12
CES1235		HIGH PRESSURE PUMP	£35
<b>CHASSIS TYPE</b>			
CES1241		FRONT WHEEL EXTENSION (+50MM OUTWARD)	£18
<b>BRAKES TYPE - NOTE: A brake option MUST be selected</b>			
CES1270		PUSH TO LOCK BRAKES	◆
CES1275		PULL TO LOCK BRAKES	○
<b>SAFETY OPTIONS TYPE</b>			
CES1345	X	TRANSPORTATION KIT (INCLUDING BUCKLE BELT)	◆
CES1361		BODYPOINT HIP BELT, 2PT, CTR-PULL PB - M X 460MM PADS, FLAT MOUNT (NOT CRASH TESTED) (NC 1362)	£69
CES1362		BODYPOINT HIP BELT, 2PT, CTR-PULL PB - L X 620MM PADS, FLAT MOUNT (NOT CRASH TESTED)	£69
CES1370		REAR ANTI-TIPPERS PAIR (NC : 1375, 1440, 1441)	£31
CES1375		REAR ANTI-TIPPERS PAIR WITH TIPPING AID (REA TYPE) (NC : 1440, 1441)	£62
CES1380		REFLECTORS KIT (FOR SPOKED WHEELS ONLY)	£6
CES1390		BRAKE EXTENSION PAIR	£12
<b>ATTENDANT OPTIONS TYPE</b>			
CES1430		CANE HOLDER	£17
CES1440		TIPPING AID RH	£12
CES1441		TIPPING AID LH	£12
<b>ACCESSORIES TYPE</b>			
CES1480		ACRYLIC TRAY (NC: 1483, 1484, 1485)	£90
CES1483		HALF TABLE TRAY, FLIP UP RH (NC: 1484)	£76
CES1484		HALF TABLE TRAY, FLIP UP LH	£76
CES1485		COMFORT PADDING FOR HALF TABLE TRAY	£38
<b>Total price:</b>			

Order No :

Customer Ref :

Non Conforming Options:	
CES0330	NYLON WITHOUT HOOK AND LOOP STRIPS SEAT UPHOLSTERY
CES0350	PADDED NYLON SEAT UPHOLSTERY
CES0471	BASIC NYLON SLING TYPE (JEMIMA)
CES0474	LOMBAR SUPPORT (+1 STRAP) BI MATERIAL PADDED COVER INCL. BACK POCKET
CES0477	CONTOUR ADJUSTABLE (3+1 STRAPS) BI MATERIAL PADDED COVER INCL. BACK POCKET
CES0478	CONTOUR ADJUSTABLE (HALF TENSION ADJUSTABLE, 3+1 STRAPS) BI MATERIAL PADDED COVER INCL. BACK POCKET (INCLUDING BACKBRACE)
CES0481	CONTOUR ADJUSTABLE (FULL TENSION ADJUSTABLE, 7+1 STRAPS) BI MATERIAL PADDED COVER INCL. BACK POCKET (INCLUDING BACKBRACE)
CES0600	FLIP UP RH FOOTPLATE
CES0610	FLIP UP DEPTH & ANGLE AJUSTABLE RH FOOTPLATE
CES0611	ONE PIECE FOOTPLATE - DEPTH & ANGLE ADJUSTABLE
CES0620	FLIP UP LH FOOTPLATE
CES0630	FLIP UP DEPTH & ANGLE AJUSTABLE LH FOOTPLATE
CES0660	SWING AWAY DETACHABLE DESK ARM RH (N°2) 24 CM HEIGHT
CES0670	SWING AWAY DETACHABLE FULL ARM RH (N°2) 24 CM HEIGHT
CES0680	SWING AWAY DETACHABLE DESK ARM RH (N°3) TUBULAR ADJ. IN HEIGHT
CES0690	SWING AWAY DETACHABLE FULL ARM RH (N°3) TUBULAR ADJ. IN HEIGHT & DEPTH
CES0738	REMOVABLE MUDGUARD RH (N°6) (CUSHION IS RECOMMENDED FOR SEAT HEIGHT 41 & 43.5 CM) HEIGHT ADJUSTABLE
CES0740	REMOVABLE DESK ARM LH (N°1) ADJ 20-23-26- 28 CM HEIGHT
CES0750	REMOVABLE FULL ARM LH (N°1) ADJ 20-23-26-28 CM HEIGHT
CES0760	SWING AWAY DETACHABLE DESK ARM LH (N°2) 24 CM HEIGHT
CES0770	SWING AWAY DETACHABLE FULL ARM LH (N°2) 24 CM HEIGHT
CES0780	SWING AWAY DETACHABLE DESK ARM LH (N°3) TUBULAR ADJ. IN HEIGHT
CES0790	SWING AWAY DETACHABLE FULL ARM LH (N°3) TUBULAR ADJ. IN HEIGHT & DEPTH
CES0795	REMOVABLE DESK ARM LH (N°4) ADJ. IN HEIGHT
CES0796	REMOVABLE FULL ARM LH (N°4) ADJ IN HEIGHT & DEPTH
CES0832	REMOVABLE LH (N°4) ARMPAD HEMI DARTEX MULTI POSITION
CES0838	REMOVABLE MUDGUARD LH (N°6) (CUSHION IS RECOMMENDED FOR SEAT HEIGHT 41 & 43.5 CM) HEIGHT ADJUSTABLE
CES0905	NECKREST, DARTEX (INCLUDING BACKBRACE)
CES0906	HEADREST, DARTEX (INCLUDING BACKBRACE) SIDEWAYS ADJUSTABLE
CES0907	HEADREST WITH CHEEK SUPPORT, DARTEX (INCLUDING BACKBRACE) SIDEWAYS ADJUSTABLE
CES0930	ADJUSTABLE CALF STRAP
CES0935	LONGER FOOTREST TUBE
CES0936	SHORTER FOOTREST SUPPORT (PAIR)
CES0940	BACKBRACE
CES0945	FOLDING BACKBRACE
CES0952	IN-RIGGED ARMREST
CES1010	8" X 1.1/4" SOLID TYRE
CES1030	8" X 2" SOLID TYRE
CES1049	6" X 1.1/4" SOLID TYRE MEDIUM HARD
CES1050	6" X 1.1/4" SOLID TYRE
CES1051	5" X 1.1/4" SOLID TYRE
CES1052	5" 1/2 X 1" 3/4 SOLID TYRE MEDIUM HARD
CES1114	24" LIGHTWEIGHT REAR WHEEL/BLACK SOLID TYRE
CES1117	22" LIGHTWEIGHT REAR WHEEL/PNEUMATIC TYRE
CES1118	24" LIGHTWEIGHT REAR WHEEL/PNEUMATIC TYRE
CES1119	24" LIGHTWEIGHT REAR WHEEL/MARATHON PLUS TYRE
CES1190	STANDARD REAR WHEELS POSITION
CES1200	PASSIVE REAR WHEELS POSITION
CES1201	DUAL AMPUTEE REAR WHEELS POSITION (6 CM / BACKREST CANE AXLE, ADJUSTABLE TO 8.5 CM)
CES1260	SPOKE PROTECTORS PAIR, BLACK
CES1261	SPOKE PROTECTORS PAIR, CLEAR
CES1275	PULL TO LOCK BRAKES
CES1280	ATTENDANT HUB BRAKES (INCLUDING PUSH TO LOCK BRAKES)
CES1370	REAR ANTI-TIPPERS PAIR
CES1375	REAR ANTI-TIPPERS PAIR WITH TIPPING AID (REA TYPE)
CES1380	REFLECTORS KIT (FOR SPOKED WHEELS ONLY)
CES1390	BRAKE EXTENSION PAIR
CES1440	TIPPING AID RH
CES1441	TIPPING AID LH
CES1480	ACRYLIC TRAY
CES1483	HALF TABLE TRAY, FLIP UP RH
CES1484	HALF TABLE TRAY, FLIP UP LH
CES1485	COMFORT PADDING FOR HALF TABLE TRAY

Order No :

Customer Ref :



1190 Standard Rear Wheel Position  
 1200 Passive Rear Wheel Position



1201 Dual Amputee Rear Wheel Set Back Position

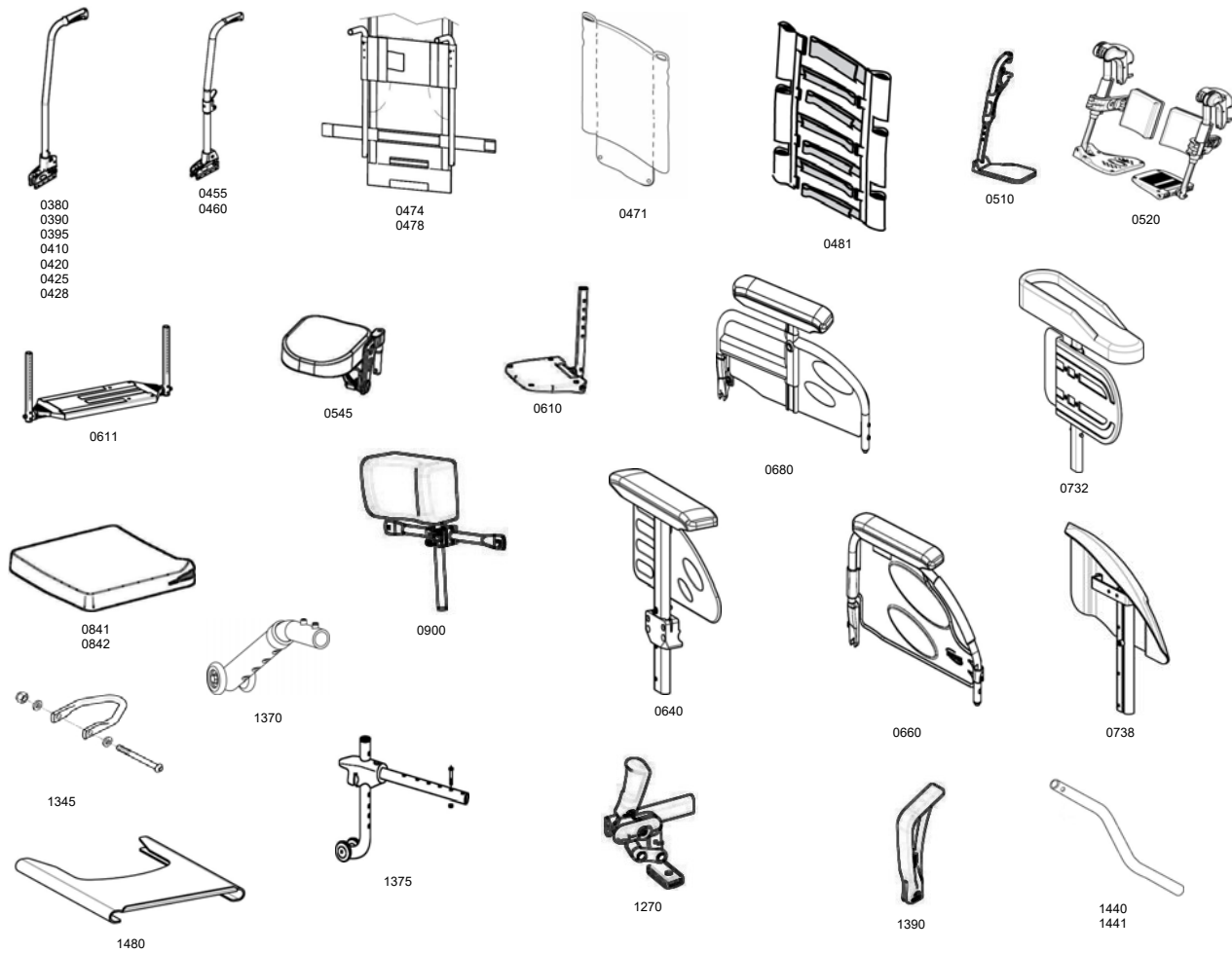

Please refer to our Invacare Unique special order form, for more complex custom requirements. Available at [www.invacare.co.uk](http://www.invacare.co.uk)

**Special Instructions - Please supply the following information:**

**Name:** \_\_\_\_\_ **Email:** \_\_\_\_\_  
**Phone:** \_\_\_\_\_ **Fax:** \_\_\_\_\_

**Description of special request (please include relevant option code or part number):**