

ACTA-RELIEF™ LTS ORDER FORM



Acta-Relief Patent Pending



Shown with Compass® 4 Quick Release 2 Point Hardware.
Cover appearance may vary with hardware selection.

Company Name/ACCT #: _____
 P.O. Number: _____
 Requested By: _____
 Phone: _____ Fax: _____
 Email: _____
 Ship To: _____
 Patient Reference: _____

1 SIZE SELECTION Required

BASE RRP

LENGTH*	22"	£831.00			
	20"				
	18"				
	16"				
	14"				
	12"				
		14"	16"	18"	20"
		FRAME WIDTH			

Sizes available are subject to hardware being used.

ARLTS-BS

Please fill in one of the above with dimensions from the size charts to the right.
 Example Part: **ARLTS-BS14W16L**

Hardware will be selected in Section 2.

IF DESIRED SIZE IS NOT LISTED, PLEASE CONTACT
 CUSTOMER SERVICE FOR ASSISTANCE.
 00.353.719163905

*Length (L) refers to the actual size dimension of the support from bottom to top edge.

Sizes available with 2 POINT Mounting Hardware

LENGTH*	22"	14W22L	16W22L	18W22L	20W22L
	20"	14W20L	16W20L	18W20L	20W20L
	18"	14W18L	16W18L	18W18L	20W18L
	16"	14W16L	16W16L	18W16L	20W16L
	14"	14W14L	16W14L	18W14L	20W14L
	12"	14W12L	16W12L	18W12L	20W12L
		14"	16"	18"	20"
		FRAME WIDTH			

Sizes available with 4 POINT Mounting Hardware

LENGTH*	22"	14W22L	16W22L	18W22L	20W22L
	20"	14W20L	16W20L	18W20L	20W20L
	18"	14W18L	16W18L	18W18L	20W18L
	16"	14W16L	16W16L	18W16L	20W16L
	14"	14W14L	16W14L	18W14L	20W14L
	12"				
		14"	16"	18"	20"
		FRAME WIDTH			

Sizes available with POWER Mounting Hardware

LENGTH*	22"	14W22L	16W22L	18W22L	20W22L
	20"	14W20L	16W20L	18W20L	20W20L
	18"	14W18L	16W18L	18W18L	20W18L
	16"	14W16L	16W16L	18W16L	20W16L
	14"	14W14L	16W14L	18W14L	20W14L
	12"	14W12L	16W12L	18W12L	20W12L
		14"	16"	18"	20"
		FRAME WIDTH			

ACTA-RELIEF-LTS-ORDER REV0418

2 COVER & HARDWARE SELECTION

Required

2.1 COVER SELECTION

RRP £0.00

Both fabrics are latex-free. Fabric selection is for the support surface only. Other fabrics used in cover construction remain the same.

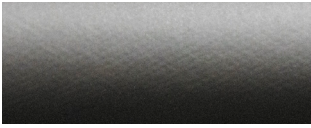

COMFORT-TEK™ is a smooth, easily cleaned surface. The fluid protection aids in infection control.



STRETCH-AIR™ has comfortable stretch, air transmission and heat dissipation. It is not fluid resistant.

COMFORT-TEK™ Cover
(COMFORT-TEK)

STRETCH-AIR™ Cover
(STRETCH-AIR)

2.2 HARDWARE STYLE

COMPASS® 4 QUICK RELEASE

Price included in back support purchase

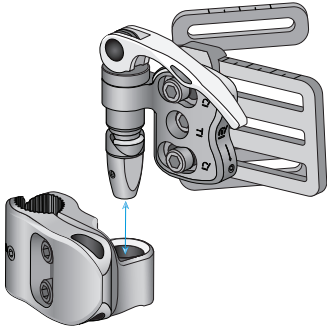

QUICK RELEASE 2 POINT (Q-COMPASS)
QUICK RELEASE 4 POINT (Q-COMPASS4)

4 POINT hardware is required on all 24"W back supports using Compass® 4 hardware.

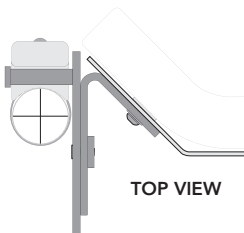

COMPASS® 4 FIXED

Price included in back support purchase

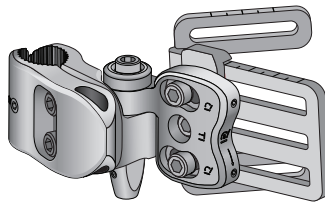

FIXED fully adjustable hardware requires tools for back support removal

FIXED 2 POINT (NQ-COMPASS)
FIXED 4 POINT (NQ-COMPASS4)

COMPASS® POWER MOUNT

RRP add £28.00

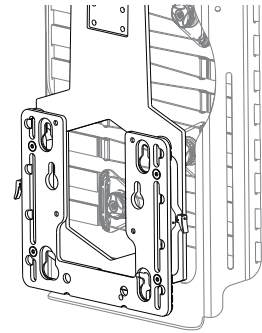

POWER MOUNT hardware has 8" of height adjustment in 1/2" increments without using tools.

QUANTUM w/ TRU BALANCE 3 (PMB-QUANTUM)
PERMOBIL w/ CORPUS 3G (PMB-PERMOBIL)
QUICKIE w/ 3.7 POWER (PMB-QUICKIE)
AVID REHAB w/ POWER T & R (PMB-AVID)
ROVI w/ MOTION CONCEPTS* (PMB-ROVI)

*Using Power Mount Hardware on ROVI requires mounting to the RECESSED PLANAR INTERFACE PLATE available when ordering the Motion Concepts Seating System. Drilling is required for mounting.

3 LATERAL TRUNK SUPPORT SELECTION

3.1 Required (3.2 Optional)

3.1 LATERAL TRUNK SUPPORT

Price included in back support purchase

Length (L) refers to the actual size dimension of the support from top to bottom edge.
Depth (D) refers to the actual size dimension of the support from anterior to posterior edge.

- LTS back supports come with moldable stainless steel supports and rigid mounting hardware.
- Hardware is width and depth adjustable. Height adjustable on back support shell. Adjustments require tools.

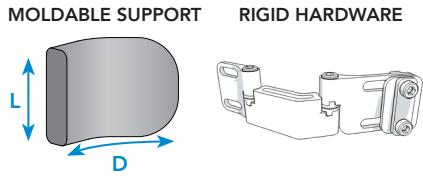

Size	Cover Style	
4" D x 3" L	COMFORT-TEK™ (LAT-4D3L-COMFORT-TEK)	
	STRETCH-AIR™ (LAT-4D3L-STRETCH-AIR)	
5" D x 4" L	COMFORT-TEK™ (LAT-5D4L-COMFORT-TEK)	
	STRETCH-AIR™ (LAT-5D4L-STRETCH-AIR)	
6" D x 4" L	COMFORT-TEK™ (LAT-6D4L-COMFORT-TEK)	
	STRETCH-AIR™ (LAT-6D4L-STRETCH-AIR)	
7" D x 5" L	COMFORT-TEK™ (LAT-7D5L-COMFORT-TEK)	
	STRETCH-AIR™ (LAT-7D5L-STRETCH-AIR)	

COMFORT-TEK™
is a smooth, easily cleaned surface. The fluid protection aids in infection control.

STRETCH-AIR™
has comfortable stretch, air transmission and heat dissipation.

3.2 ADDITIONAL LATERAL TRUNK SUPPORT HARDWARE OPTIONS

SWING-AWAY HARDWARE

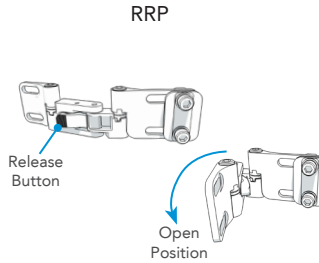

LEFT		*EXTRA LEFT	
	BL-LTS-GT1SAK-LH		BL-LTS-GT1SAK-LH
RIGHT		*EXTRA RIGHT	
	BL-LTS-GT1SAK-RH		BL-LTS-GT1SAK-RH

Hardware is width and depth adjustable. Height adjustable on back support shell. Adjustments require tools.

*"EXTRA" parts may not fit depending on back support, pad, and hardware size and style combinations.

EXTRA HARDWARE LINKS

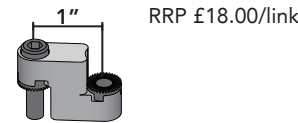

LEFT		ADD'L LEFT	
	BL-LTS-GT1LINK		BL-LTS-GT1LINK
RIGHT		ADD'L RIGHT	
	BL-LTS-GT1LINK		BL-LTS-GT1LINK

HARDWARE COVER

RRP £17.00/cover



LEFT		EXTRA LEFT	
	BL-LTS-HCOVER		BL-LTS-HCOVER
RIGHT		EXTRA RIGHT	
	BL-LTS-HCOVER		BL-LTS-HCOVER

4 BACK SUPPORT ADD-ON SELECTIONS

Optional

4.1 COLOR

RRP £24.00

Accent colors are applied via colored piping. Placement of the piping may vary by back support size and mounting hardware. If no colors are selected, our standard silver reflective piping is used at no additional cost.



RED (RED)
PURPLE (PURPLE)
PINK (PINK)
BLUE (BLUE)
GREEN (GREEN)
ORANGE (ORANGE)
REMOVE (REMOVE)

4.2 EMBROIDERY

RRP £24.00

A. THREAD COLOR OPTIONS

RED (EMB-RED)	BLUE (EMB-BLUE)
PURPLE (EMB-PURPLE)	GREEN (EMB-GREEN)
PINK (EMB-PINK)	SILVER (EMB-SILVER)

B. FONT OPTIONS

Helvetica (EMB-Helvetica)	Twilight (EMB-Twilight)
Garamond (EMB-Garamond)	Script (EMB-Script)

C. WORD ONE

WORD TWO (optional)

*ADDITIONAL LEAD TIMES MAY APPLY

4.3 PRIVACY FLAP

RRP £33.00

This flap connects with hook & loop attachment between the seat and back for added privacy.

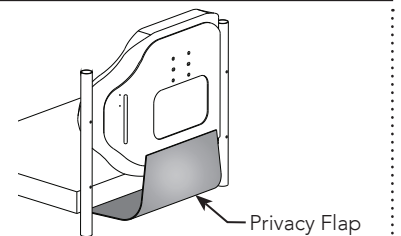

5 BODILINK® HEAD SUPPORT HARDWARE & PADS

5.1 PREMIUM PAD SIZE

RRP £98.00

Length (L) refers to the actual size dimension of the support from bottom to top edge.

W		Pad Firmness	
L	6W x 3L	Soft	BL-HSP1-6W3L
		Extra Soft	BL-HSP2-6W3L
L	8W x 4L	Soft	BL-HSP1-8W4L
		Extra Soft	BL-HSP2-8W4L
L	10W x 5L <i>with adjustable wings</i>	Soft	BL-HSP1-10W5L
		Extra Soft	BL-HSP2-10W5L
L	12W x 5L <i>with adjustable wings</i>	Soft	BL-HSP1-12W5L
		Extra Soft	BL-HSP2-12W5L
L	14W x 5L <i>with adjustable wings</i>	Soft	BL-HSP1-14W5L
		Extra Soft	BL-HSP2-14W5L
L	18W x 5L <i>with adjustable wings</i>	Soft	BL-HSP1-18W5L
		Extra Soft	BL-HSP2-18W5L



Premium Head Support Pads angles can be formed by adjusting the plates in the pad.

5.2 PREMIUM PAD COVER MATERIAL



FOR SKIN PROTECTION & SHEAR REDUCTION. NOT FLUID RESISTANT.

COMFORT-TEK



FOR FLUID PROTECTION & AN EASILY CLEANED SURFACE.

STRETCH-AIR



FOR AIR TRANSMISSION & HEAT DISSIPATION.

GlideWear® (GLIDEWEAR) (additional cost)

Comfort-Tek (COMFORT-TEK)

Stretch-Air (STRETCH-AIR)

5.3 BASIC PAD SIZE

RRP £69.00

Length (L) refers to the actual size dimension of the support from bottom to top edge.

W		
L	6W x 5L	BL-HSP3-6W5L
L	8W x 5L	BL-HSP3-8W5L
L	10W x 6L	BL-HSP3-10W6L
L	12W x 6L	BL-HSP3-12W6L
L	14W x 6L	BL-HSP3-14W6L
L	18W x 6L	BL-HSP3-18W6L



Basic head support pads can be formed to any shape using the moldable steel insert inside the pad.

5.4 BASIC PAD COVER MATERIAL

COMFORT-TEK



FOR FLUID PROTECTION & AN EASILY CLEANED SURFACE.

STRETCH-AIR



FOR AIR TRANSMISSION & HEAT DISSIPATION.

Comfort-Tek (COMFORT-TEK)

Stretch-Air (STRETCH-AIR)

5.5 HEAD SUPPORT HARDWARE

- You may make one selection per column in either A -or- B.
- If choosing 5.5 A, choose a stem length option to the right.
- Choose which mounting block option you require in 5.6.

A. PT HARDWARE, REMOVABLE

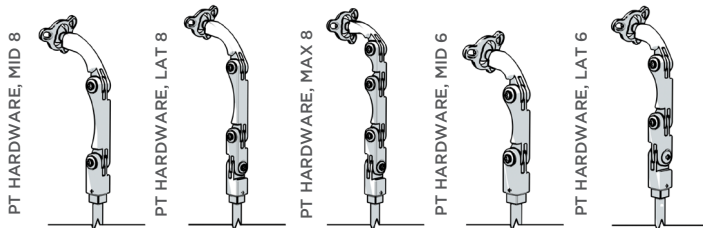

SIZE & SHAPE	RRP
MID 8	£134.00
LAT 8	£159.00
MAX 8*	£134.00
MID 6	£159.00
LAT 6	£187.00

PART NUMBER
(BL-HS-PT1RMMID8)
(BL-HS-PT1RMLAT8)
(BL-HS-PT1RMMAX8)
(BL-HS-PT1RMMID6)
(BL-HS-PT1RMLAT6)

*Provides the greatest amount of articulation and range of motion.

PT HARDWARE RANGE OF MOTION

PT MODEL	TOTAL # OF LINKS	TOTAL LINK LENGTH	MAX. ANTERIOR REACH	MAX. POSTERIOR REACH	MAX. LATERAL REACH
MID 8	2	8"	7.5"	1"	N/A
LAT 8	3	8"	7.5"	1"	8"
MAX 8	4	8"	7.5"	3"	8"
MID 6	2	6"	5.5"	1"	N/A
LAT 6	3	6"	5.5"	1"	6"

PT HARDWARE (CONTINUED)
PT HARDWARE, STEM LENGTH OPTION

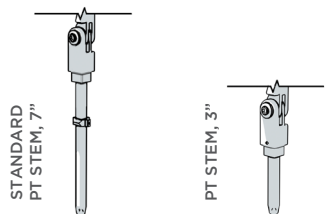

STEM LENGTH	RRP	PART NUMBER	
STANDARD 7" STEM	£0.00	(HS-STEM-7)	
***3" STEM	£0.00	(HS-STEM-3)	

***3" Stem is recommended for use with power mounting where there may be special constraints with power chair functions

B. GT HARDWARE, REMOVABLE

GT HARDWARE RANGE OF MOTION

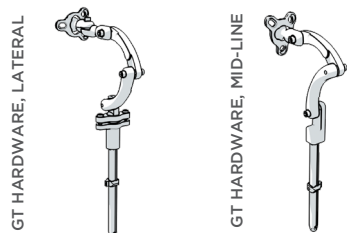

GT MODEL	TOTAL # OF LINKS	TOTAL LINK LENGTH	MAX. ANTERIOR REACH	MAX. POSTERIOR REACH	MAX. LATERAL REACH
LAT	5	10.5"	10"	2"	7.5"
MID	3	8.5"	8"	2"	N/A

SIZE & SHAPE	RRP	PART NUMBER	
LATERAL	£102.00	(BL-HS-GT3RMLAT)	
MID-LINE	£102.00	(BL-HS-GT3RMMID)	

5.6

HEAD SUPPORT MOUNTING OPTION

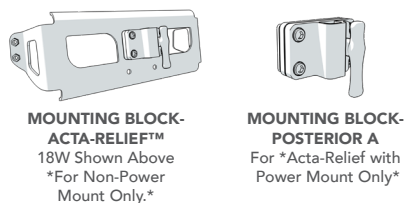

MOUNTING BLOCK OR BRACKET	RRP	PART NUMBER	
*ACTA-RELIEF™ 14W MOUNTING BLOCK	£55.00	(HS-MB-AR14W)	
*ACTA-RELIEF™ 16W MOUNTING BLOCK	£55.00	(HS-MB-AR16W)	
*ACTA-RELIEF™ 18W MOUNTING BLOCK	£55.00	(HS-MB-AR18W)	
*ACTA-RELIEF™ 20W MOUNTING BLOCK	£55.00	(HS-MB-AR20W)	
POSTERIOR A MOUNTING BLOCK	£0.00	(HS-MB-POSTA)	

*For Acta Relief™, includes mounting bracket and POSTA block.
 If you already have an Acta-Relief™ head support bracket, order POSTA Block

5.7

EXTRA HARDWARE

LINK LENGTH	RRP	EXTRA PART	
**EXTRA 2" LINK	£43.00	(BL-HS-PT1LINK2)	
**EXTRA 3" LINK	£43.00	(BL-HS-PT1LINK3)	
**EXTRA 4" LINK	£43.00	(BL-HS-PT1LINK4)	

TOOL-LESS WING LOCK	RRP	EXTRA PART	EXTRA PART	EXTRA PART	EXTRA PART
**1 LOCK	£16.00	(BL-HS-52WINGA1)	(BL-HS-52WINGA1)	(BL-HS-52WINGA1)	(BL-HS-52WINGA1)

**For PT Hardware Only

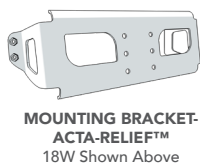

MOUNTING BLOCK OR BRACKET	RRP	PART NUMBER	
*ACTA-RELIEF™ 14W MOUNTING BRACKET	£109.00	(BL-HS-AR14W)	
*ACTA-RELIEF™ 16W MOUNTING BRACKET	£109.00	(BL-HS-AR16W)	
*ACTA-RELIEF™ 18W MOUNTING BRACKET	£109.00	(BL-HS-AR18W)	
*ACTA-RELIEF™ 20W MOUNTING BRACKET	£109.00	(BL-HS-AR20W)	

*Bracket only, does not include mounting block.



ADDITIONAL	RRP	EXTRA PART	
1/4" SPACER PLATE	£29.00	(BL-HS-SPCRA)	