



COMFORT[®]
C O M P A N Y

**USER GUIDE
& MANUAL**

BODILINK[®] HEAD SUPPORT

COMFORTCOMPANY.COM



ABOUT US

At *Comfort Company* we are dedicated to creating and manufacturing seating and postural support systems designed for people with a wide range of rehabilitation needs. Whether for pediatric, geriatric, or bariatric needs we are committed to providing our customers with quality products designed for comfort, durability, and ease of use. Our vision is to lead in the development, manufacturing, and delivery of the most innovative seating and positioning products which provide the highest level of comfort, functionality, and quality of life for the user.

CONTACT INFORMATION

 1.800.564.9248

 406.522.8563

 customerservice@comfortcompany.com

 www.comfortcompany.com



Customer Service
Bozeman, Montana



Manufacturing
New Berlin, Wisconsin

BEFORE USE

The appropriate *Comfort Company* positioning product is intended to improve every day user function and comfort while providing support and stability for a variety of rehabilitation needs. However, prior to using any *Comfort Company* support, it is important that each individual be assessed by a qualified healthcare professional for but not limited to, mobility, nutrition, current condition, goals, and health history. In addition to this initial assessment, individuals should be regularly monitored by a health care professional for any changes in their condition.

This user guide and manual is for reference purposes only and is not intended to substitute for advice given by a physician or other licensed healthcare professional. You should not use this information for self-diagnosis or self-treatment of a health problem or condition. Contact your healthcare provider immediately if you suspect that your health problem or condition has changed or worsened.

Before using, make sure that you are properly trained to operate the equipment for its application. Failure to do so could lead to discomfort, injury or damages.

NOTE: "We," "Us" and "Our" refers to *Comfort Company*. "You" refers to the product purchaser or user.

CONTENTS

SAFETY GUIDELINES	
Symbols	3
General Safety	3-4
Intended Use/User	4
Parts Detail	5
INSTALLATION & SET UP	
Attachment To Back Supports (any hardware)	6-12
Posterior Mounting Block	6
Anterior Mounting Block	7
Acta-Relief™ Mounting Bracket	8
Posterior Mounting Block to Acta-Relief™ back support with Compass® Power Mount	9
Permobil® A Mounting Block (23-28"H, Uni-Track)	10
Permobil® B Mounting Block (20"H Backs)	11
Quantum® Mounting Block (TRU-Comfort ² Backs)	12
Adding a Link to the GT Hardware	13
Adding a Link to the PT Hardware	14
Installing Tool-Less Wing Lock on PT Hardware	15
Connecting Hardware to Support Pads (any style)	16
Adjustments	16-20
Support Pad Positioning (any pad and hardware)	16
GT Style Hardware	18
PT Style Hardware	19
Finishing Installation (any hardware)	20
CLEANING AND MAINTENANCE	
Cleaning	21
Inspection	22
Reuse	22
Storage	22
Disposal	22
WARRANTY AND REPLACEMENT	
Lifetime Guarantee	22
Replacement Procedure	22

SAFETY GUIDELINES

SAFETY SYMBOLS



Warning!

Without following the specified procedure, this indicates potentially hazardous conditions that could lead to personal injury, inadequate performance, product damage or malfunction.



Prohibited!

Indicates actions that should NOT be performed at any time under any circumstance. These actions could result in personal injury and/or damage to the product or equipment being used.

GENERAL SAFETY



No Smoking

Although this product meets flammability requirements, we do not recommend smoking while using this product. Damage from smoke and flame is not covered by the lifetime warranty. You must consider additional safety precautions when choosing to smoke while using this product.



Do Not Expose to sources of excessive heat such as open flame or spark.



Do Not Cut or Puncture

Avoid sharp objects. Do not modify the product. Doing so will void its warranty and may lead to personal injury or alter the effectiveness of the product by increasing the risk factors for skin breakdown and/or instability.



You must **READ and FOLLOW** all instructions, notes and warnings included in this manual. Understanding how to care for your product is the key to safe and proper use. Share this information with all caretakers to help them meet your healthcare needs and ensure your safety.



Comfort Company cannot be held responsible for damages or injury due to misuse of the product or failure to follow instructions provided in this manual. Please contact us if you require further assistance in understanding cautions, warnings or instructions for using or maintaining your product.



Installing alternate parts to your wheelchair may change the intended structure and function of the equipment. Be sure to assess the need for additional safety features for your chair such as anti-tip bars or other available options in order to maintain stability during use. Use this manual in conjunction with the user manual that came with your chair to ensure safety guidelines are being met.



Check packaging and inspect all parts for damage before use. **DO NOT USE** if damaged and contact *Comfort Company* immediately for further instruction. Check regularly for loose components and tighten as necessary. Contact *Comfort Company* if wear or damage is noted.



During the first few hours of use, a healthcare professional should be available to observe skin condition and assess the likelihood of skin breakdown. During regular use, periodically check for skin discoloration and/or irritation. If discoloration should occur and not disappear after 30 minutes of non-use, discontinue use and consult with your healthcare provider immediately.



DO NOT place anything in between the user and the product. Additional materials may reduce the effectiveness of the product and increase risk factors for skin breakdown and instability.



Always use the cover and base with any inserts as a complete assembly. Never use a cover other than one intended for your specific product and size.

CARE SYMBOLS



Wash Cover Only - Warm Cycle (Maximum Temperature)



Do Not Wash



Hand Wash



Air Dry Only Hang to Dry



Tumble Dry Low



Do Not Tumble Dry, Steam Clean or Autoclave



Do Not Bleach



Bleach Okay



Antibacterial or Disinfectant Spray



Wipe with Water Only



Do Not Iron

Detailed cleaning instructions on page 21

PLEASE NOTE

The information in this manual was gathered and recorded with the latest specifications available at the time of publication. Due to our continued effort to reassess and improve our products, information found in this manual such as drawings and notes may vary slightly from the product that you purchased. We reserve the right to make changes to products as they are deemed necessary. To check for the latest version of this manual please visit us at www.comfortcompany.com.

The directions provided will help to maintain and extend the life of your product and ensure it is covered by the *Comfort Company Lifetime Guarantee*. Please see complete warranty information on page 22.

SAFETY GUIDELINES

BODILINK® HEAD SUPPORT SAFETY DETAILS



PROHIBITED! Never use the equipment to maneuver a chair or anything that it is attached to. It is never to be used as a handle, lift, guide or support for anything other than what it was intended. (ex. support during transfers.)



PROHIBITED! Never use the equipment unless all components are fully functional. Any issues should be addressed by contacting your dealer or customer service. Do not attempt to make your own modifications or repairs.



This product is designed for the intended user and use only. Be aware that any modifications could potentially endanger the user, cause discomfort or damage.



This product passed crash testing. However, when possible, do not use head support during transport. Repeated or excessive force (braking or crash) could potentially change adjustment or cause extra wear shortening the life of the product. Use after a crash is not recommended.



Caregivers: It is necessary to learn from a healthcare provider how to properly adjust the equipment for the user's specific positioning needs and goals.



WARNING! Ensure that the product does not interfere with any other chair components. Interference could jeopardize effectiveness and user safety as well as cause damage.



WARNING! It is necessary to fully articulate power recline features to ensure there is no possible equipment interference after installation. Do so slowly while watching closely.



ATTENTION! Make sure that the head support is securely mounted to the back support system and it is adjusted properly each time it is in use.



ATTENTION! Always check that the gear teeth in each joint of are aligned for full tooth engagement before final tightening. Failing to do so could cause wear on the teeth leading to parts slipping out of adjustment or hardware failure. (GT Hardware only)



ATTENTION! Unless otherwise specified, fasteners should be tightened to 9.6 Nm (85 lb-in).



CAUTION! Please consider that adding additional links to the hardware may reduce the overall strength.

INTENDED USE - MATERIALS

COMFORT-TEK™ fabric cover is fluid-resistant, easily cleaned at any time and soft to the touch. Comfort-Tek™ fabric has stretch which helps alleviate pressure and conforms to both support pad and user.

STRETCH-AIR™ fabric cover is 2-Ply designed to be breathable on the surface for comfort while the bottom layer is fluid-resistant for cleanliness. The multi-directional stretch allows for optimal conforming to the user and support pad shape.

GLIDEWEAR® fabric cover is intended for maximum hair and skin protection by reducing shear. Recommended most for those with abnormal tone causing involuntary movements, difficult postures and frequent repositioning

All fabrics used in BodiLink® Head Support covers are latex-free. Comfort-Tek™ fabric is used on all head support pad covers along the outer edge.

BodiLink® Premium Head Support Pads come in two levels of firmness (soft and extra soft). Both use a layer of Viscool® extra soft foam over a high resiliency foam base layer. This combination allows for immersion and conforming to the user for optimal surface contact, comfort and pressure redistribution.

BodiLink® Basic Head Support Pads come in one firmness using two layers of high resiliency foam. The softer top layer is for comfort as well as durability.

INTENDED USER

BodiLink® head support is intended for those with positioning and support needs as deemed necessary by a qualified healthcare professional.

BodiLink® head support offers a wide variety of available positions to accommodate user rehabilitation needs and goals while allowing for function and comfort. The sizes available and range of adjustability fit pediatric to full grown users and should be matched by the healthcare provider to suit the user needs. Adjustments or replacement components may be necessary as changes in condition occur or to accommodate developments such as growth.

BodiLink® Head Support (HS) Hardware and Pads

GT Removable Hardware

Mid-line Hardware Lateral Hardware

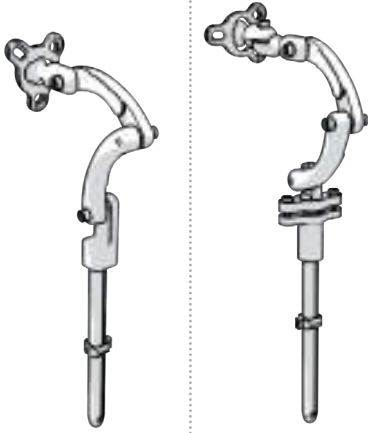

PT Removable Hardware - with either 7" or 3" Hardware Stem

Mid-6 Hardware Mid-8 Hardware Lat-6 Hardware Lat-8 Hardware Max-8 Hardware

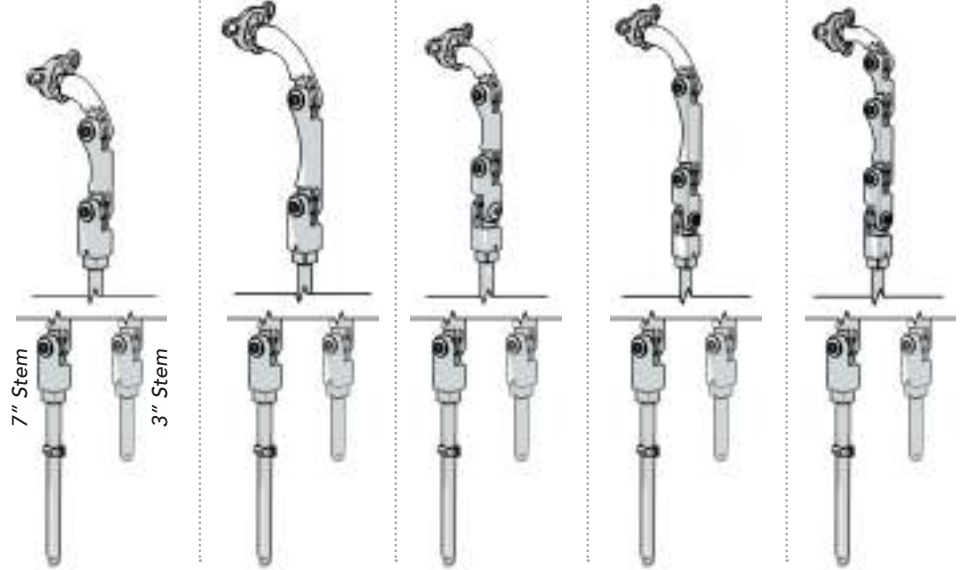

Mounting Hardware

Posterior Mounting Block

Anterior Mounting Block

Permobil A Mounting Block

Corpus Back Supports 23" - 28"H

Permobil B Mounting Block

Corpus Back Supports 20"H

Quantum A Mounting Block

TRU-Comfort® Back Supports

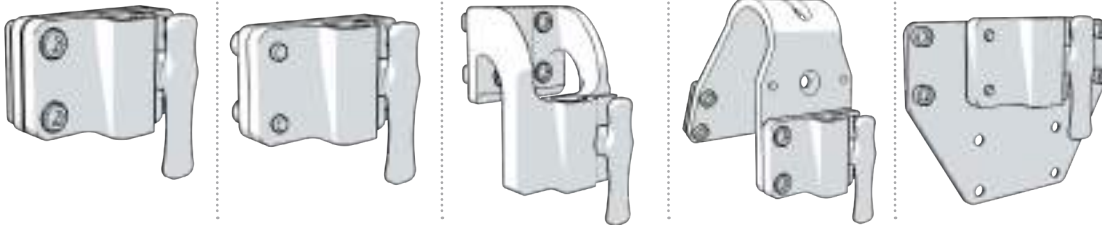

Acta-Relief™ HS Mounting Bracket with Mounting Block

Acta-Relief™ HS Mounting Bracket Only

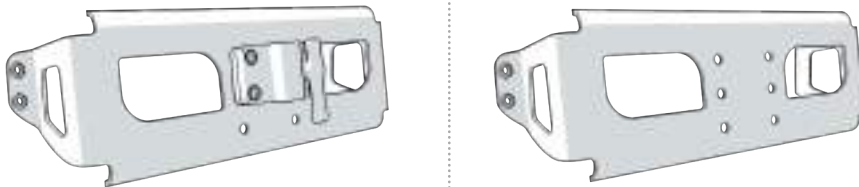

Support Pads

BodiLink® HS Basic Pads

6"W x 5"L

8"W x 5"L

10"W x 6"L

12"W x 6"L

14"W x 6"L

18"W x 6"L

BodiLink® HS Premium Pads

6"W x 3"L

8"W x 4"L

10"W x 5"L

12"W x 5"L

14"W x 5"L

18"W x 5"L

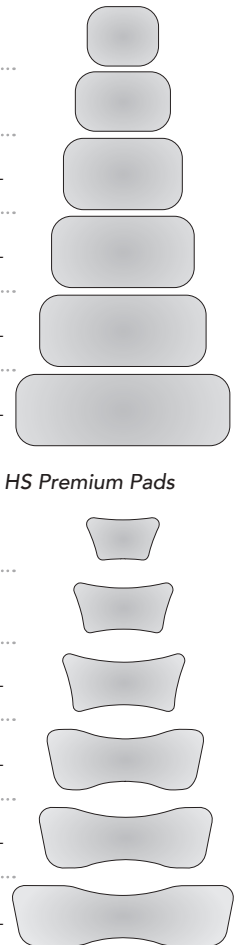

Additional Hardware

1/4" Spacer Plate

For Posterior & Anterior Mounting Blocks

Tool-Less Wing Lock

For PT Hardware Only

Extra 2" Link

For PT Hardware Only

Extra 3" Link

For PT Hardware Only

Extra 4" Link

For PT Hardware Only



INSTALLATION (POSTERIOR MOUNTING BLOCK)

For Acta-Back®, Acta-Back® Deep, Acta-Back® Contour, Acta-Back® LTS, Acta-Embrace®, Acta-Embrace® LTS, & Visco Back®.

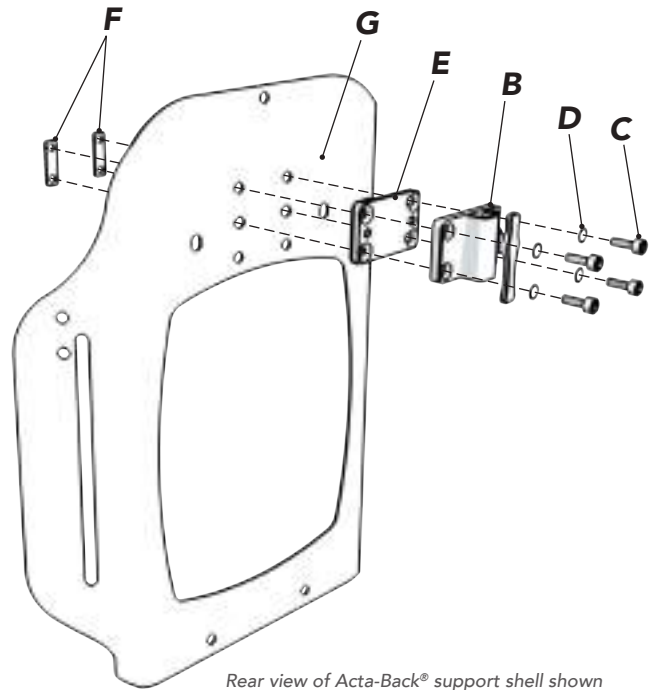
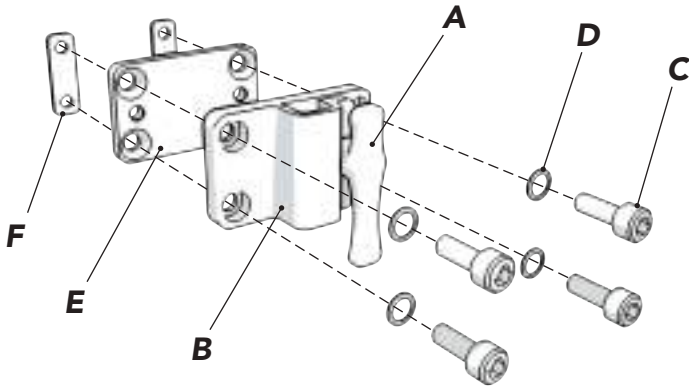

Rear view of Acta-Back® support shell shown

- 1 If head support hardware stem is inserted in mounting block **B**, turn knob **A** counterclockwise to release it and set aside.
- 2 Using 5mm hex key, loosen screws **C** to release washers **D**, spacer plate **E**, and double nuts **F** from mounting block **B**.
- 3 Move back support cover (not pictured) allowing access from both sides to head support holes on back support shell **G**.
- 4 Align mounting block **B** and spacer plate **E** with desired set of holes on back support shell **G** and double nuts **F**.
Note: Use of spacer plate **E** is optional. If not using, shorter screws are provided to replace **C**.
- 5 Replace screws **C** and washers **D** and tighten.
- 6 Replace and secure back support cover.
- 7 Insert hardware stem into mounting block **B** and turn knob **A** clockwise to secure. Note: Make sure at least ½" of hardware stem is completely through the bottom of **B** at all times. See pages 16-20 for final adjustments.

For Radius Back® or other OEM Back Supports utilizing T-nut Head Support mounting.

- 1 If head support hardware stem is inserted in mounting block **B**, turn knob **A** counterclockwise to release it and set aside.
- 2 Align mounting block **B** and spacer plate **E** with T-nuts on back support **H**. Note: Radius Back® requires creating holes in the back support cover at the T-nut locations for attaching mounting hardware.
- 3 Fasten with screws **J** and washers **D**.
- 4 Insert hardware stem into mounting block **B** and turn knob **A** clockwise to secure. Note: Make sure at least ½" of hardware stem is completely through the bottom of **B** at all times. See pages 16-20 for final adjustments.

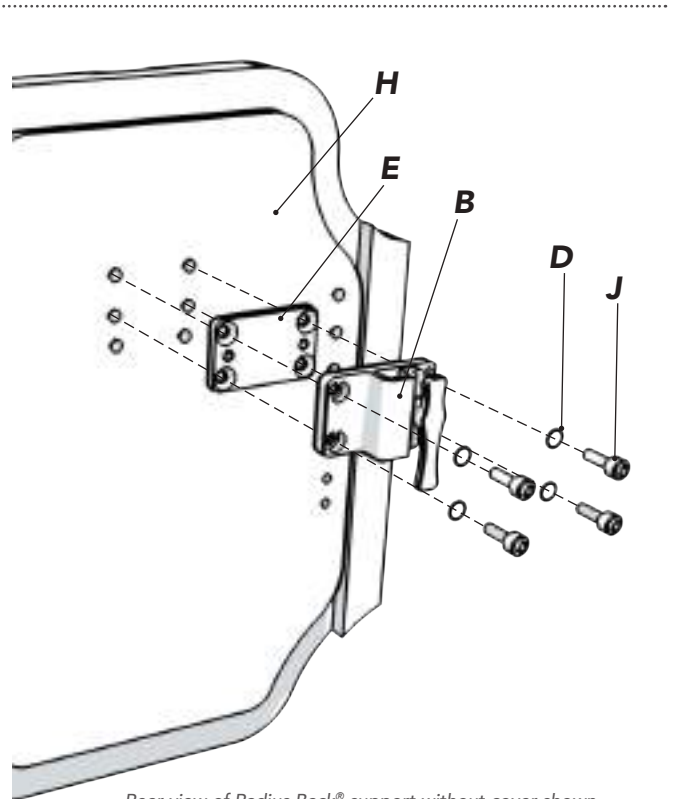

Rear view of Radius Back® support without cover shown

INSTALLATION (ANTERIOR MOUNTING BLOCK)

For back supports where threading from anterior surface of the shell is necessary or preferred.

- 1 If head support hardware stem **C** is inserted in mounting block **B**, turn knob **A** counterclockwise to release it and set aside.
- 2 Loosen button head screws **D** with 4mm hex key and remove along with washers **E** and spacer plate **F** from mounting block **B**.
- 3 Remove back support cover (not pictured) allowing access from both sides to head support holes on back support shell **G**.
- 4 Align mounting block **B** and spacer plate **F** with available head support holes on the back support shell **G**.
- 5 Attach **B** and **F** with screws **D** and washers **E** from the front face of the back support shell **G** and tighten.
- 6 Replace and secure back support cover.
- 7 Insert hardware stem **C** into mounting block **B** and turn knob **A** clockwise to secure. Note: Make sure at least ½" of stem **C** is completely through the bottom of **B** at all times. See pages 16-20 for final adjustments.

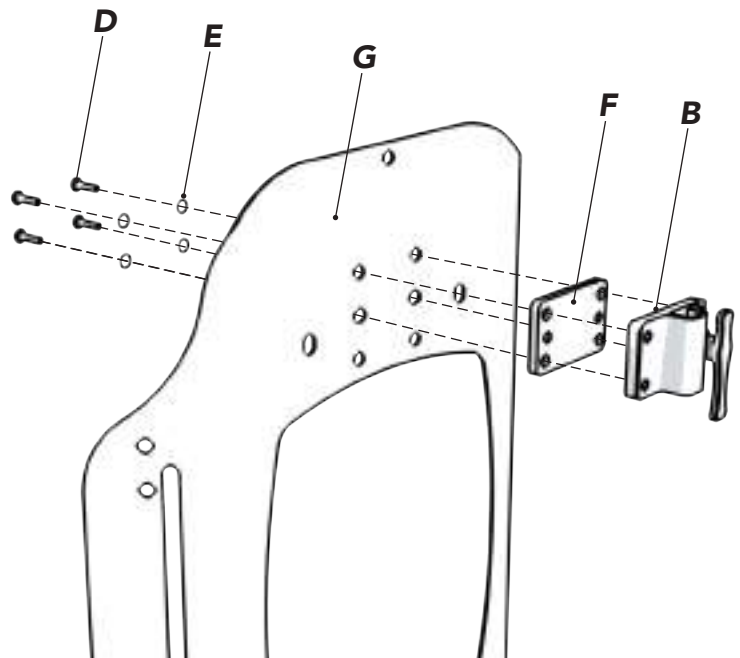
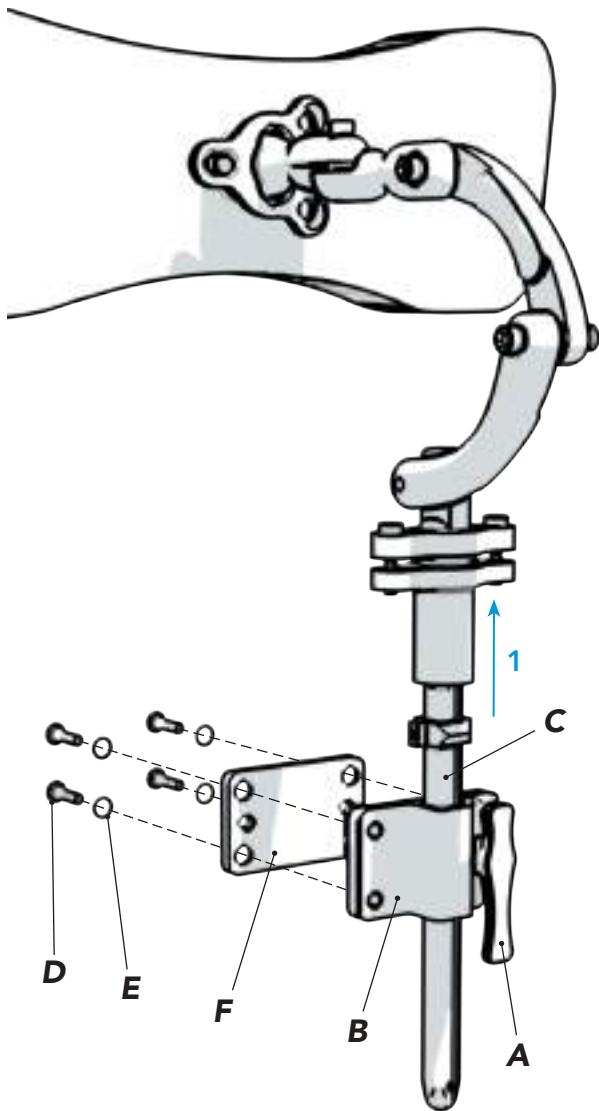

For OEM back supports with a 2-hole head support mounting pattern. Instructions to be used in combination with images above.

- 1 Loosen screws **D** with 4mm hex key and remove along with washers **E** and spacer plate **F** from mounting block **B**.
- 2 Use flat head screws **H** provided with countersunk holes in spacer plate **F** to attach it to mounting block **B**. Make sure the screw heads are flush with spacer plate **F** when tightened.
- 3 Align remaining threaded holes **J** on spacer plate with holes on the back support.
- 4 Attach using shorter button head screws provided (not shown) and existing washers **E**. See pages 16-20 for final adjustments.

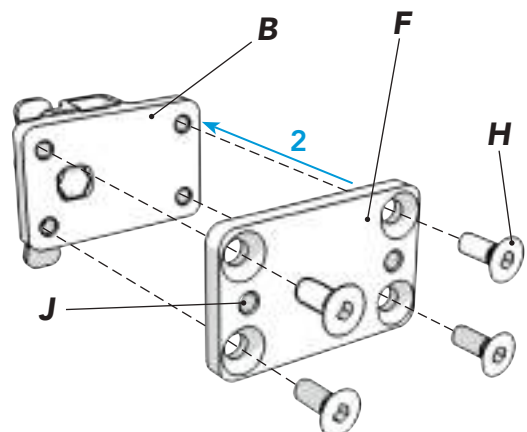

INSTALLATION (ACTA-RELIEF™)

For Acta-Relief™ & Acta-Relief™ LTS using Compass® 4 Mounting Hardware.

If Acta-Relief™ Head Support Bracket is already attached to shell, please skip to step 2.

- 1 Align holes on back support shell **G** with head support bracket **H** and attach with fasteners and hex key provided. The bracket should be oriented with the curved edge of the side faces at the bottom.

Assembly order:

screw **J** - safety washer **K** - flat washer **L** - **G** - **H**

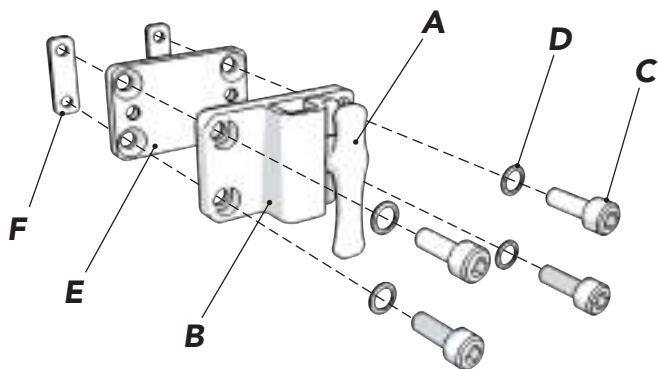
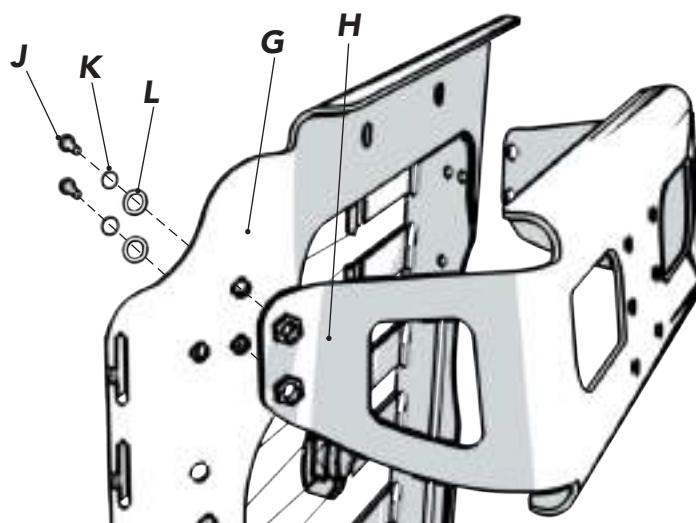

- 2 If head support hardware stem is inserted in mounting block **B**, turn knob **A** counterclockwise to release it and set aside.
- 3 Using 5mm hex key, loosen screws **C** to release washers **D**, spacer plate **E**, and double nuts **F** from mounting block **B**.
- 4 Align mounting block **B** and spacer plate **E** with desired set of holes on head support bracket **H** and double nuts **F**.
- 5 Replace screws **C** and washers **D** and tighten.
- 6 Insert hardware stem into mounting block **B** and turn knob **A** clockwise to secure. Note: Make sure at least 1/2" of hardware stem is completely through the bottom of **B** at all times. See pages 16-20 for final adjustments.

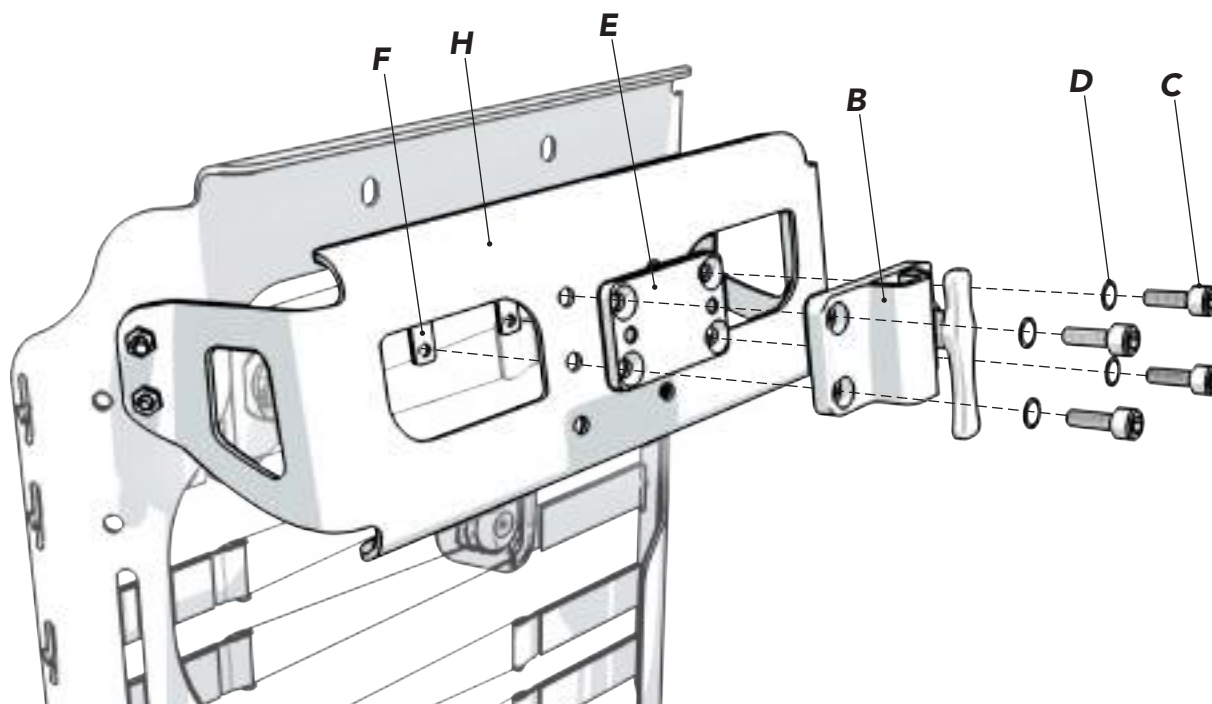

INSTALLATION (ACTA-RELIEF™ POWER)

For Acta-Relief™ & Acta-Relief™ LTS using Compass® Power Mount Hardware.

- 1 If head support hardware stem **C** is inserted in mounting block **B**, turn knob **A** counterclockwise to release it and set aside.
- 2 Using 5mm hex key, loosen screws **D** to release washers **E**, spacer plate **F**, and double nuts **G** from mounting block **B**.
Note: Use of spacer plate **F** is optional and may affect clearance in certain recline situations. If not using the spacer plate, shorter screws are provided to replace **D**.
- 3 Align mounting block **B** with desired set of head support holes on power mount bracket **H** and double nuts **G**.
- 4 Replace screws **D** and washers **E** and tighten.
- 5 Insert hardware stem **C** into mounting block **B** and turn knob **A** clockwise to secure. Note: Make sure at least ½" of hardware stem **C** is completely through the bottom of **B** at all times. See pages 16-20 for final adjustments.

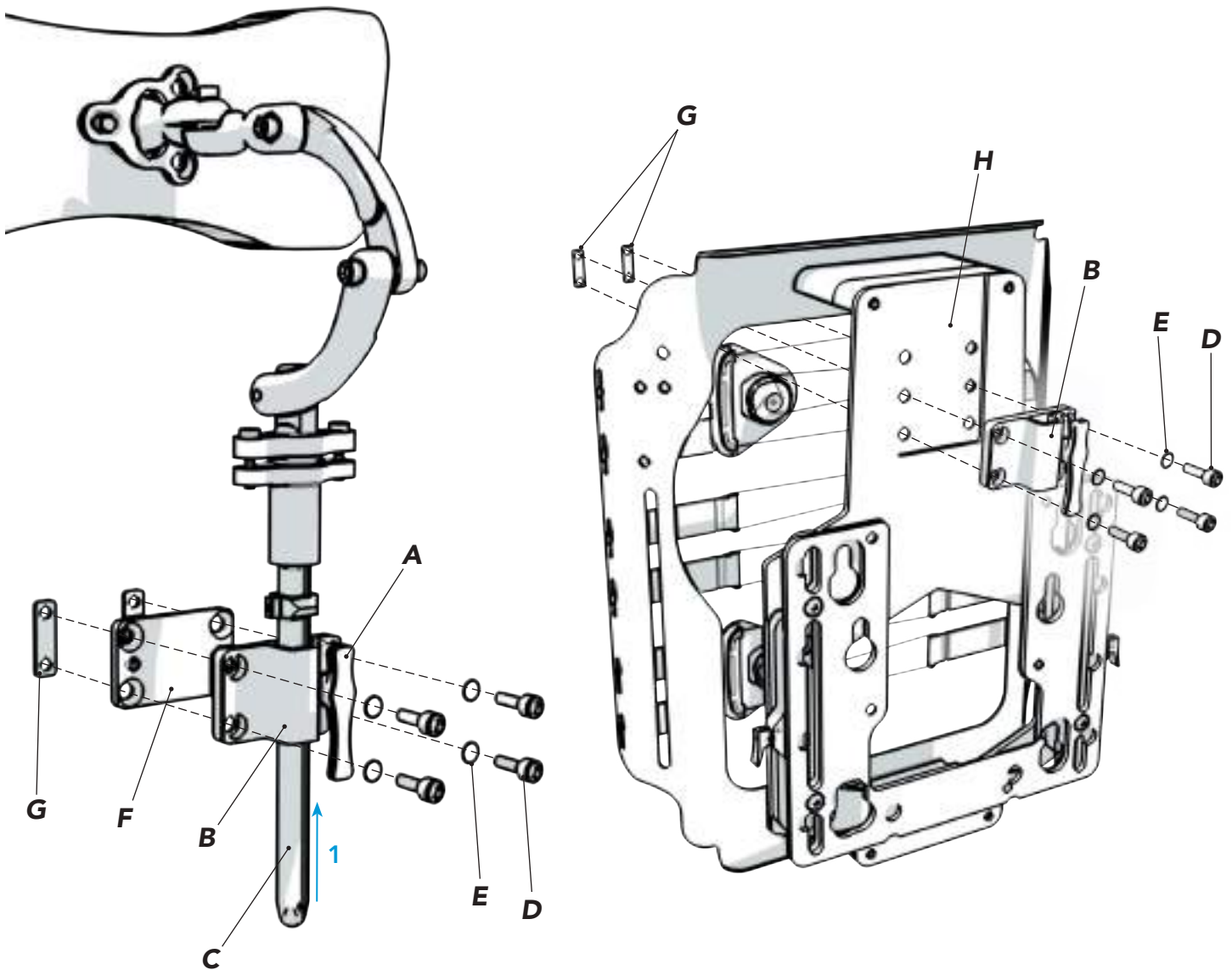

INSTALLATION (PERMOBIL A MOUNTING BLOCK)

For Permobil® Corpus Back Supports 23" - 28"H with Uni-Track System using Permobil A Mounting Block.

- 1 If head support hardware stem **C** is inserted in mounting block **B**, turn knob **A** counterclockwise to release it and set aside.
- 2 Using 5mm hex key, loosen but not remove screws **D** to create a gap between double nuts **E** and mounting block **B**.
- 3 Slide double nuts **E** into Uni-Track System slots and move into position.
- 4 Tighten screws **D** with 5mm hex key to secure.
- 5 Insert hardware stem **C** into mounting bracket **B** and turn knob **A** clockwise to secure. Note: Make sure at least ½" of stem **C** is completely through the bottom of **B** at all times. See pages 16-20 for final adjustments.

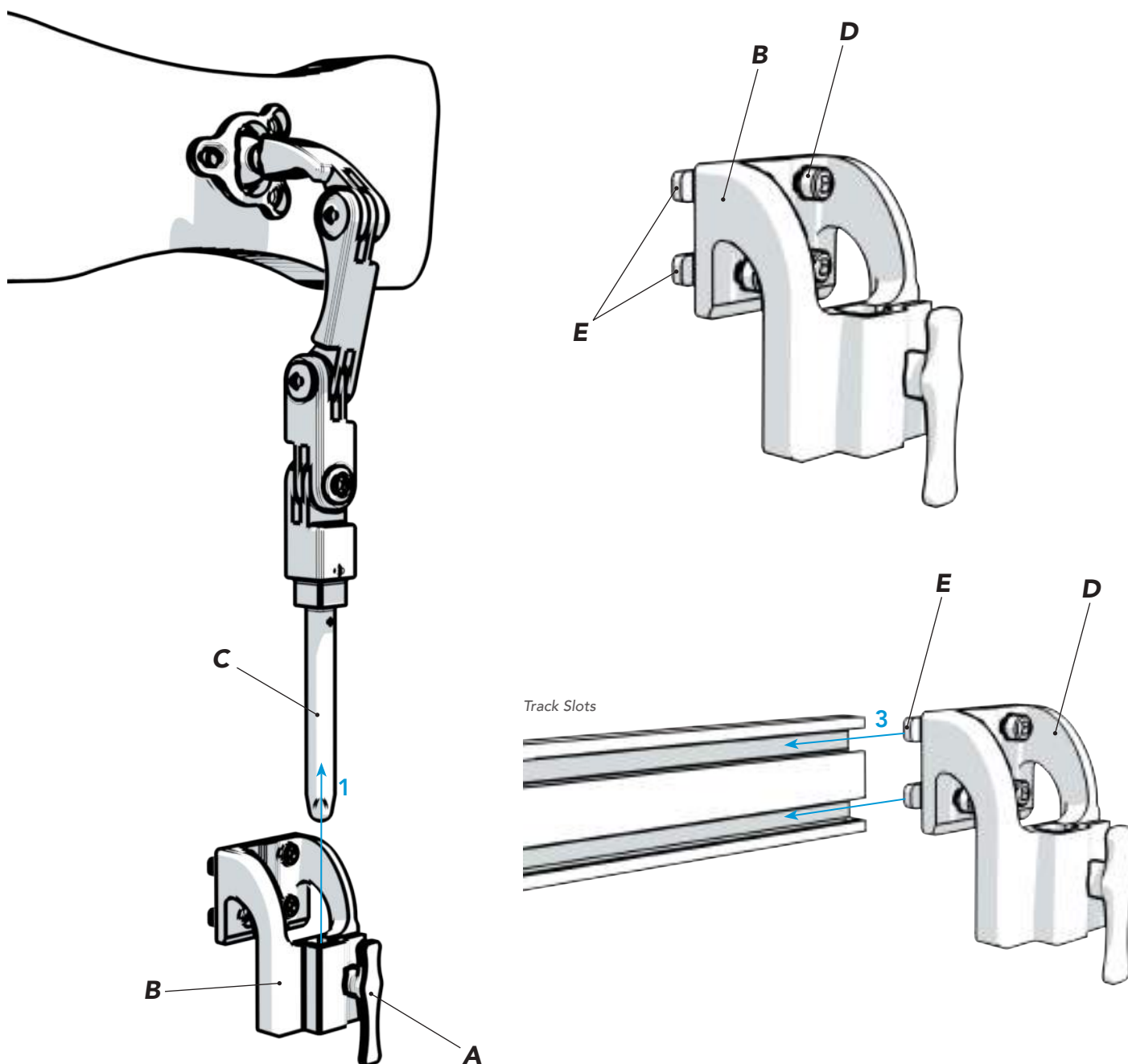

INSTALLATION (PERMOBIL B MOUNTING BLOCK)

For Permobil® Corpus Back Supports 20"H using Permobil B Mounting Block.

- 1 If head support hardware stem is inserted in mounting block **B**, turn knob **A** counterclockwise to release it and set aside.
- 2 Using 5mm hex key, loosen screws **C** to release washers **D**, and double nuts **F** from mounting bracket **E**.
- 3 Move back support cover (not pictured) allowing access from both sides to head support holes on back support shell **G**.
- 4 Align mounting bracket **E** with head support holes on back support shell **G** and double nuts **F**.
- 5 Replace screws **C** and washers **D** and tighten.
- 6 Replace and secure back support cover.
- 7 Insert hardware stem into mounting block **B** and turn knob **A** clockwise to secure. Note: Make sure at least ½" of hardware stem is completely through the bottom of **B** at all times. See pages 16-20 for final adjustments.

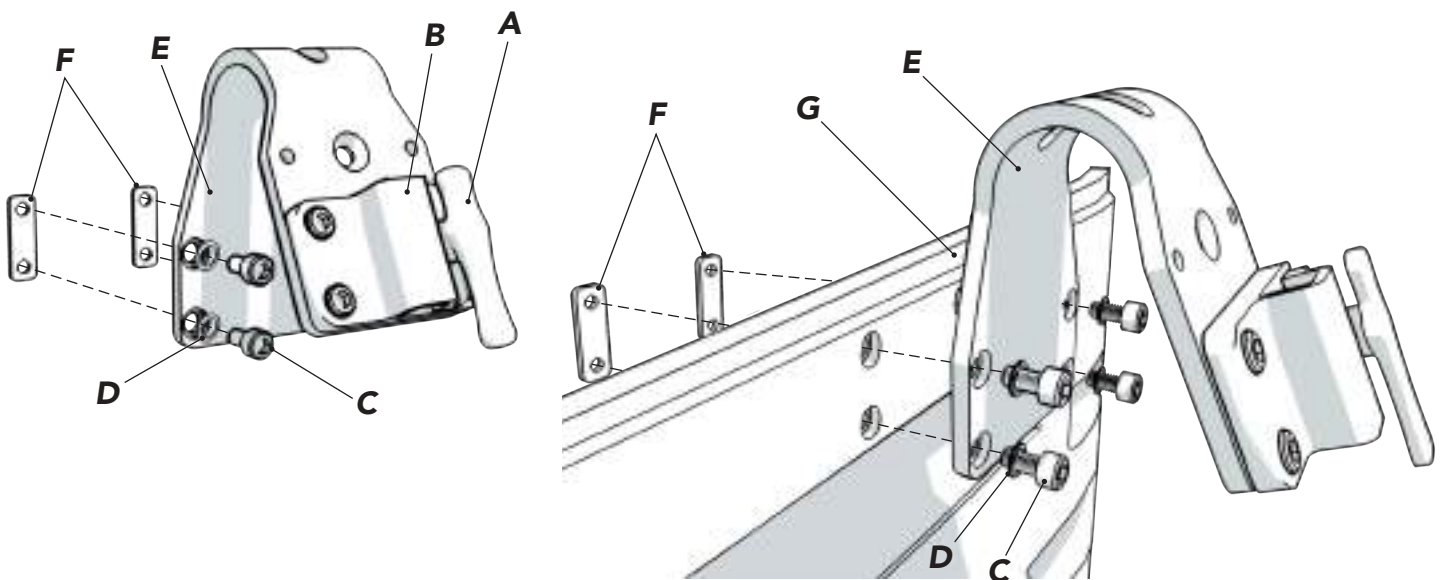

Alternate options when using Permobil B Mounting Block.

- 1 Remove screws **G** and washers **H** on mounting block **B**.
- 2 Align mounting block **B** with alternate holes on mounting bracket **E**.
- 3 Replace screws **G** and washers **H** and tighten.

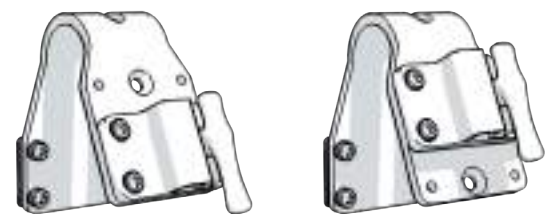
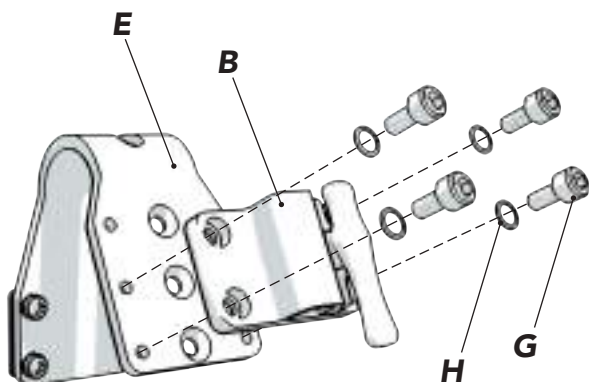

Standard and Alternate Mounting Block Placement on Mounting Bracket

Note: Additional Corpus Seating System accessory rail can be attached to the inner face of mounting bracket if needed using the countersunk holes on the mounting bracket. Access countersunk holes using instructions to the left. Please refer to accessory rail instructions for proper attachment and use.

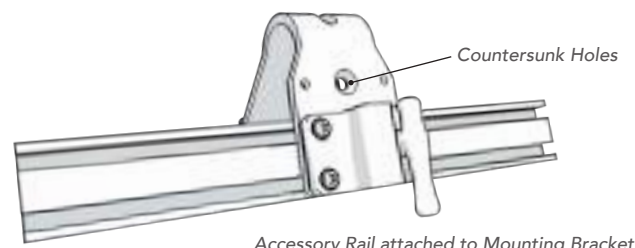

Accessory Rail attached to Mounting Bracket

INSTALLATION (QUANTUM MOUNTING)

For Quantum® TRU-Comfort² Back Supports on TRU-Balance³ Seating System using Quantum Mounting Block.

- 1 If head support hardware stem is inserted in mounting block **B**, turn knob **A** counterclockwise to release it and set aside.
- 2 Attach mounting plate **C** to back support **G** with socket head screws **E** and tighten using 4mm allen wrench.
- 3 Insert hardware stem into mounting bracket **B** and turn knob **A** clockwise to secure.
Note: Make sure at least ½" of stem is completely through the bottom of **B** at all times. See pages 16-20 for final adjustments.

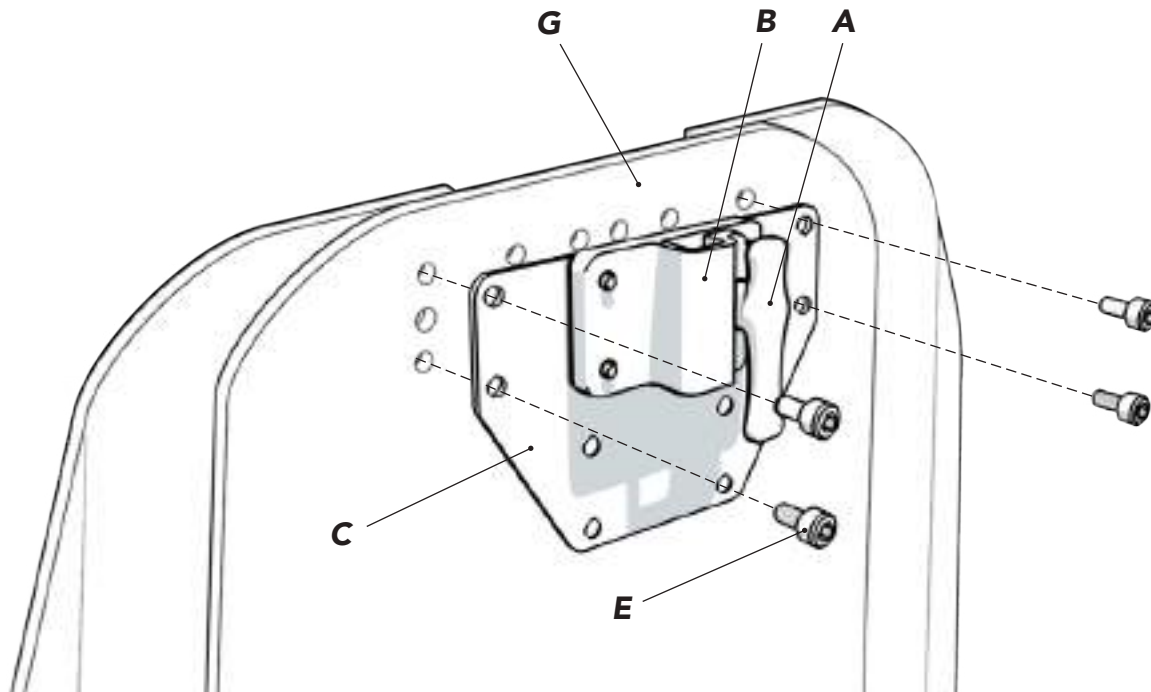

Alternate option when using Quantum Mounting Block.
Instructions to be used in combination with images above.

Note: This process can not be completed if mounting bracket **C** is already mounted to the back support.
Remove screws **E** (pictured above) prior to step 1 if needed.

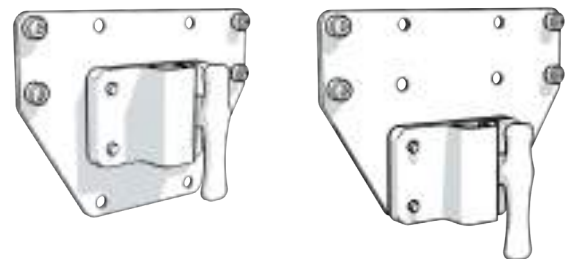
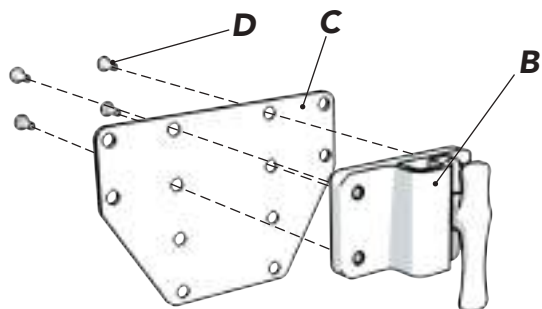

Alternate Mounting Block Placement on Mounting Bracket

- 1 Remove flat head screws **D** on mounting plate **C** using phillips head screwdriver.
- 2 Align mounting block **B** and alternate countersunk holes of mounting plate **C** and attach with flat head screws **D**.
Make sure the screw heads are flush with mounting plate **C** when tightened.

INSTALLATION (ADDING A LINK TO GT HARDWARE)

BodiLink® Head Support GT Lateral Hardware will include an extra link and fasteners to use if needed to reach extreme positions.



CAUTION! Please consider that adding additional links to the hardware may reduce the overall strength.

- 1 Remove screw **D** and safety washer **E** from curved link **F** and top of hardware stem **C**.
 - 2 Remove hardware stem **C** from mounting bracket **B** by turning knob **A** counterclockwise.
 - 3 Turn hardware stem **C** 180° so the visible gear teeth are facing the opposite direction.
 - 4 Insert hardware stem **C** into mounting bracket **B** and turn knob **A** clockwise to secure.
- Note: Make sure at least ½" of stem **C** is completely through the bottom of **B** at all times.

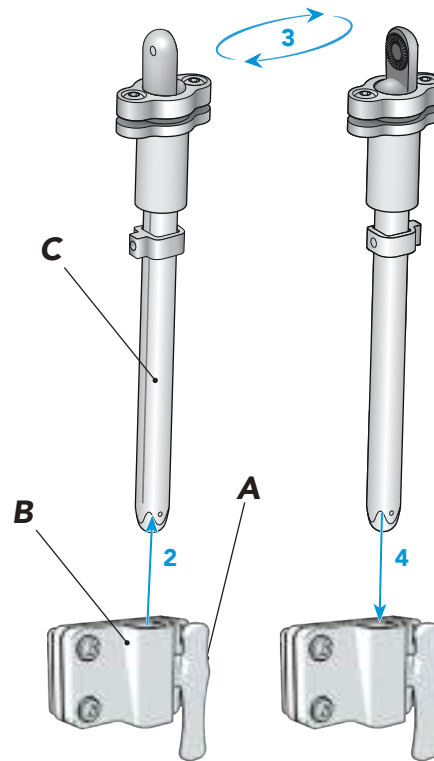
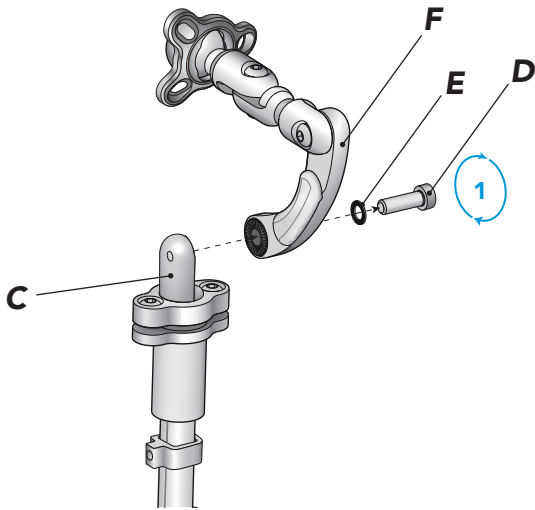

- 5 Align extra link **G** with gear teeth on hardware stem **C** in the orientation shown below and fasten with safety washer **H** and screw **J**.
- 6 Align the other end of extra link **G** with curved link **F** and fasten with safety washer **E** and screw **D**.
- 7 See pages 16-20 for information on final adjustments.

! Proper gear tooth alignment and engagement is essential for a secure set up.

Gear Tooth Alignment

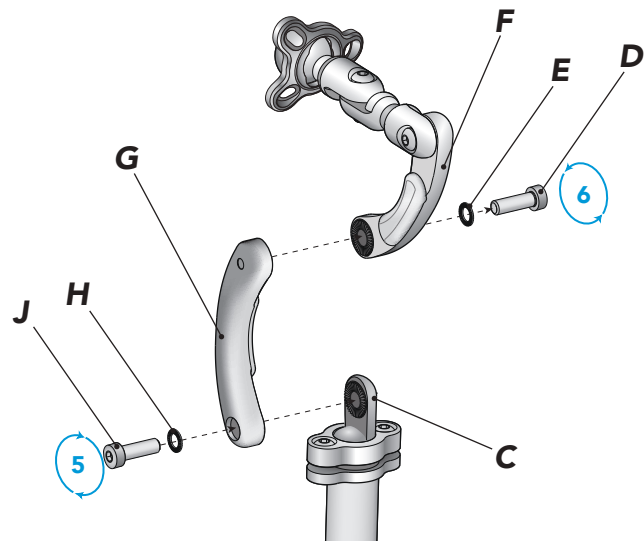
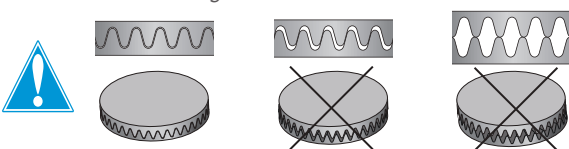

INSTALLATION (ADDING A LINK TO PT HARDWARE)

BodiLink® PT Hardware Extra 2", 3", and 4" Links.
Taper inserts may be oriented so screws face either left or right.

- 1 Remove screw **A** and safety washer **B** from taper insert **C**. Separate link **D** and ball link **E**.
- 2 Align new link **F** with link **D**.
- 3 Place existing taper insert **C** halves (countersunk side first) in end of link **D** making sure the square ends are aligned inside for a low-profile fit in the joint. Countersunk side of all taper inserts **C** should consistently face the same direction on hardware so that screws **A** are all on the same side.
- 4 Insert screw **A** and safety washer **B** into countersunk side of taper insert **C** and tighten. Hold the threaded side of taper insert **C** firmly while fastening.
- 5 Align new link **F** joint with ball link **E**.
- 6 Place new taper insert **G** halves (countersunk side first) in the end of ball link **E** making sure the square ends are aligned inside for a low-profile fit in the joint.
- 7 Insert screw **H** and safety washer **J** into countersunk side of taper insert **G** and tighten. Hold the threaded side of taper insert firmly while fastening.

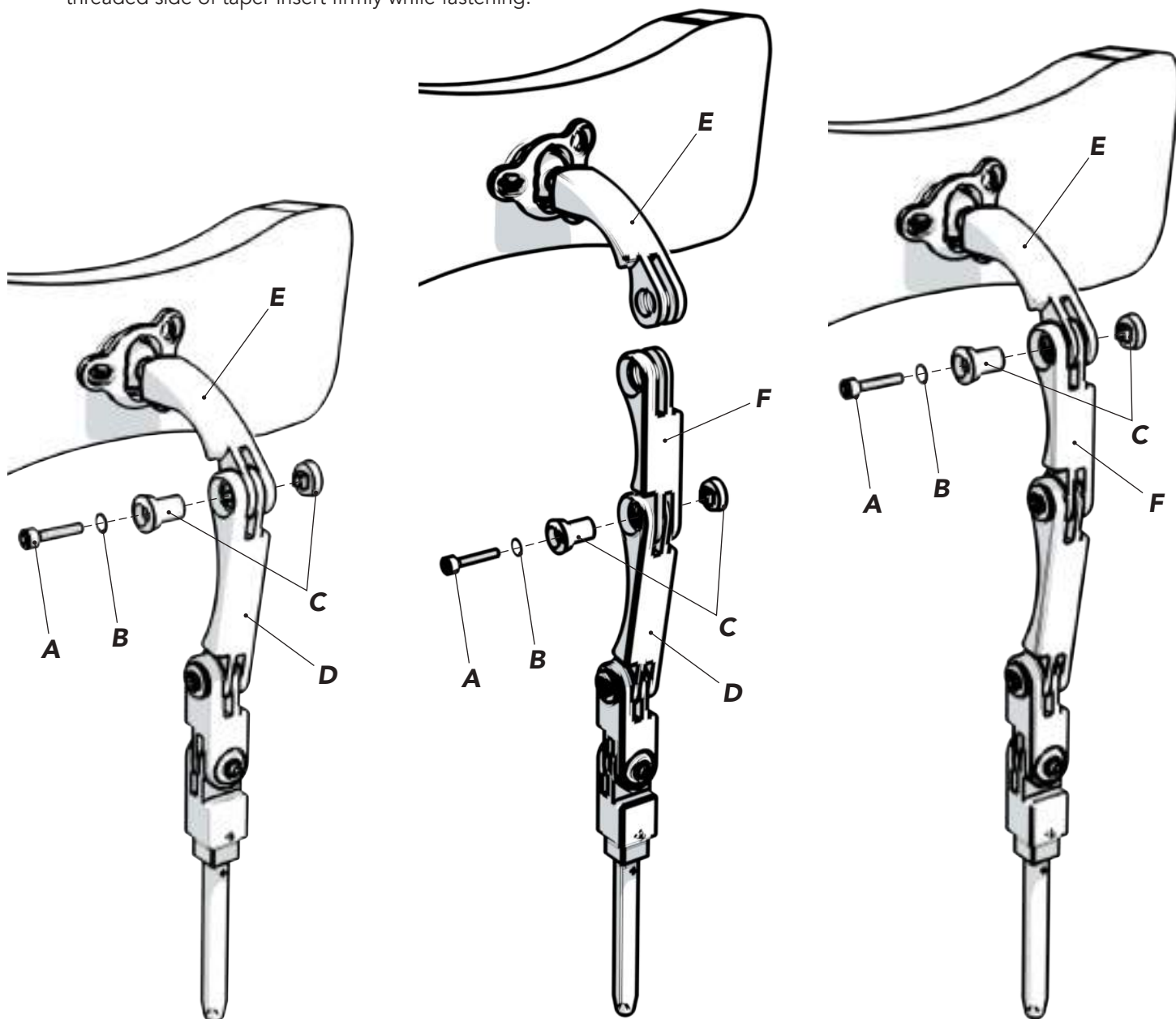

INSTALLATION (TOOL-LESS WING LOCK)

BodiLink® PT Hardware Tool-Less Wing Lock.

Taper inserts may be oriented so screws and wing locks face either left or right.

- 1 Remove screw **A** and safety washer **B** from taper insert **C** in the joint you will be replacing with a wing lock.
- 2 Remove threaded half of taper insert **C** and replace with threaded end from wing lock **D** making sure the squares of **D** and the remaining countersunk half of **C** are aligned inside for a low-profile fit in the joint.
- 3 Insert wing lock **E** and safety washer **F** into taper lock **C** half and tighten. Hold the taper lock **D** firmly while fastening.
- 4 Align retainer clip **G** with tip of wing lock **E** and press on hard. The convex side of the retainer clip must face out. Note: the retainer clip is very difficult to remove once installed. Adding it to the wing lock assembly should be considered a permanent change.
- 5 Repeat steps 1 through 4 for each joint being replaced with a wing lock.

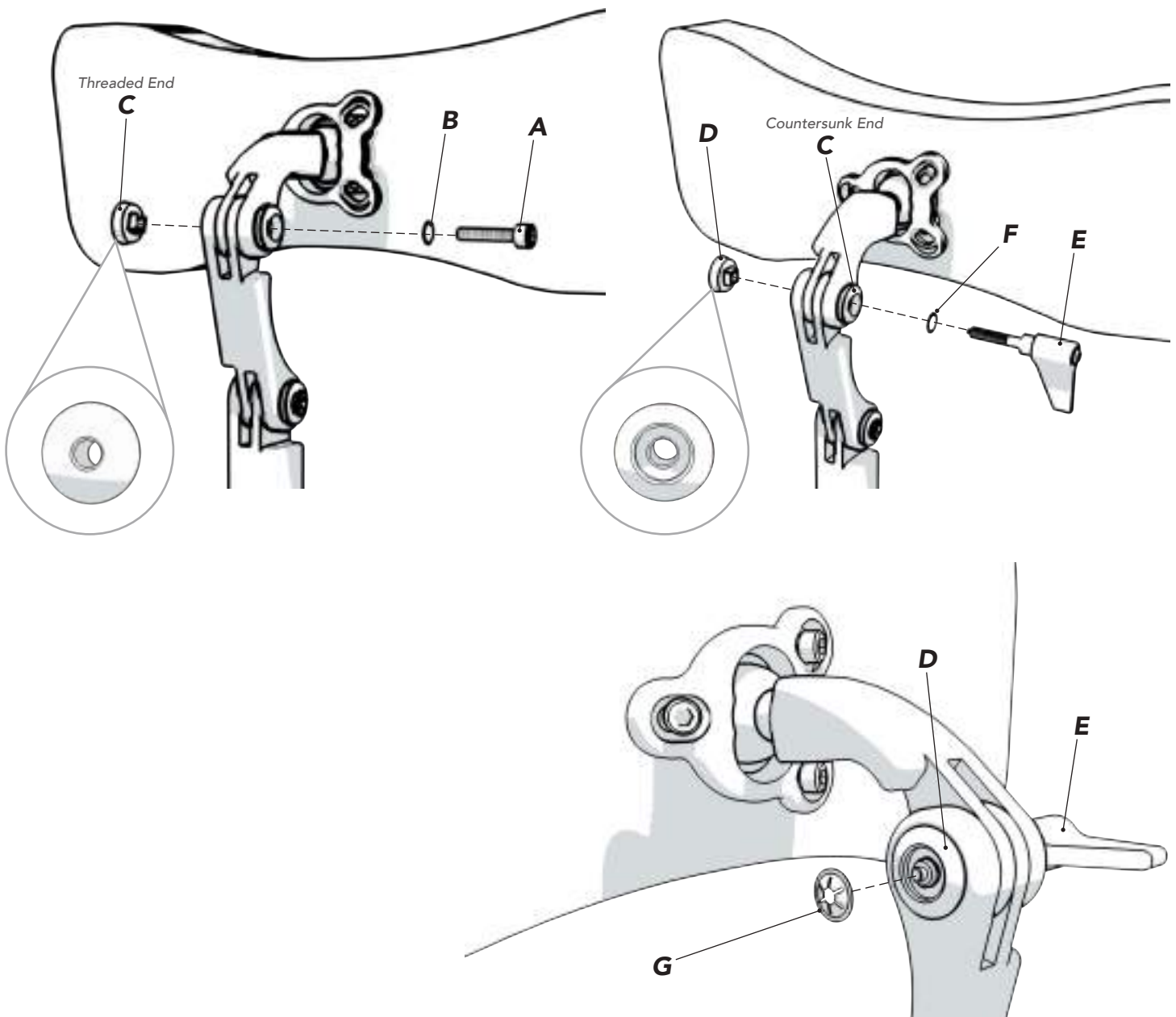

INSTALLATION (SUPPORT PAD)

Instructions apply to both Basic and Premium pads with any style of hardware.

- 1 Align ball link **A** and ball ring **B** with ball receiver **C**.
- 2 Loosely engage screws **D** and safety washers **E** with ball receiver **C** to complete the assembly.
- 3 Continue through page 20 for final adjustments.

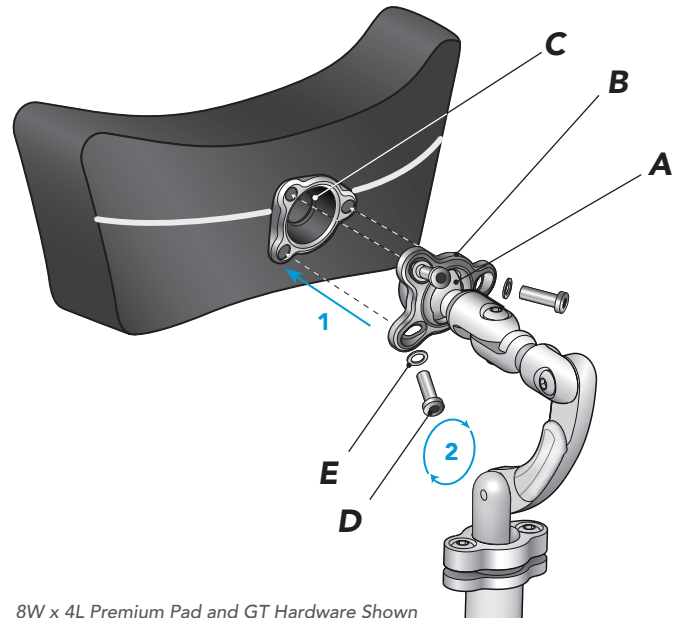

8W x 4L Premium Pad and GT Hardware Shown

SET UP & ADJUSTMENTS (PADS)

Final pad positioning should be completed in conjunction with hardware adjustments detailed on following pages. Premium BodiLink® Head Support pads have a preformed curvature for optimal posterior contact, and 10 - 18" W pads have 2 points of adjustment for additional lateral support.

- 1 Loosen all hardware adjustment point screws allowing for full articulation of the head support to a desired position. Loose screws **A** around ring **B** will allow pad orientation adjustment.

Note: Premium BodiLink® head support pads are designed to be used in any orientation including flipped 180° as shown.

- 2 PREMIUM PADS: To access wing adjustment screws **C** on 10" - 18"W pads, partially unzip the locking zippers under the cover flaps. Screw heads are accessible in the channels. Ensure gear teeth are properly aligned before final tightening.
- 3 BASIC PADS: Mold pad by bending with hands or over a firm surface. Basic pads not pictured.

! **ATTENTION:** If screws **A** are not evenly tightened all around ring **B**, unwanted movement may occur. Additionally, the gear teeth on premium wing adjustments must be properly aligned and engaged for a secure setup.

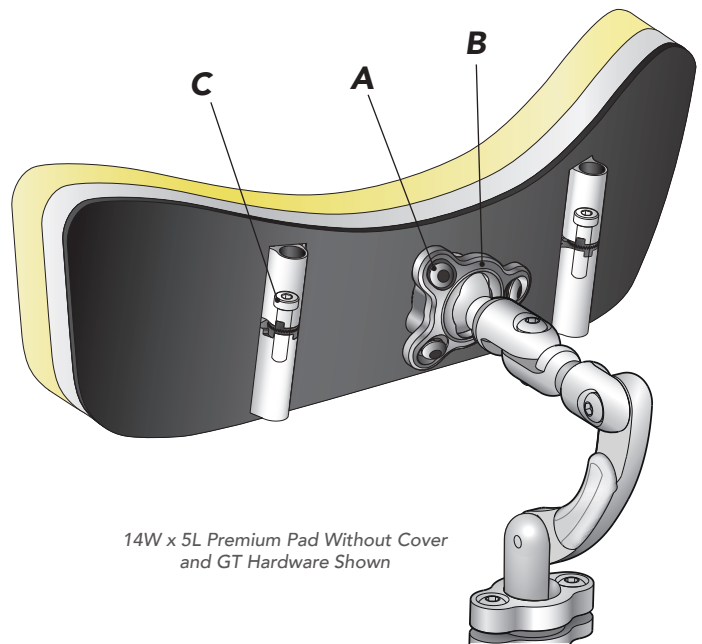

14W x 5L Premium Pad Without Cover and GT Hardware Shown

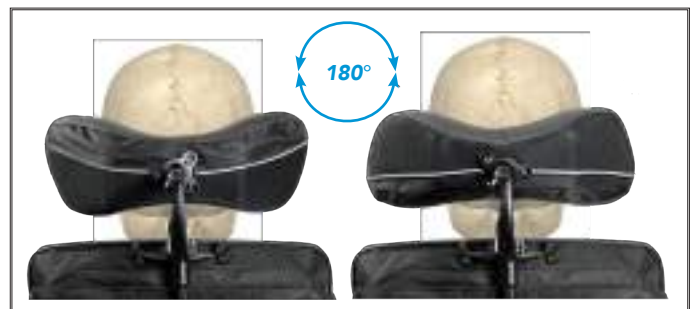

Gear Tooth Alignment

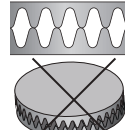
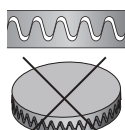
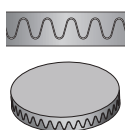

SET UP & ADJUSTMENTS (HARDWARE)

All BodiLink® Head Support hardware styles have adjustment for height* and depth to be used in combination with pad positioning described on previous page. Some hardware styles also have lateral positioning features. For GT Hardware, see page 18. For PT hardware, see page 19.

GT Hardware

Mid-line Positioning Only

Lateral Positioning Available



PT Hardware

Mid-line Positioning Only

Lateral Positioning Available

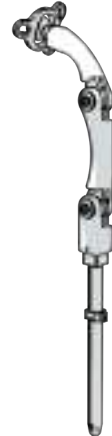

Mid-6

Mid-8

Lat-6

Lat-8

Max-8

*Amount of height adjustment available is dependent on the stem length ordered



Lateral GT Hardware with Additional Link Shown



Max 8 PT Hardware with 7" Stem Shown

SET UP & ADJUSTMENTS (GT HARDWARE)

Lateral Style GT Hardware (without additional link added) shown. Mid-line GT hardware will not have angle adjustment points. Adjustments to be made simultaneously with pad positioning adjustments.

A = Angle/Lateral Offset

D = Depth

H = Height

- 1 Loosen all hardware adjustment point screws allowing for full articulation of the head support to a desired position.
- 2 Hold hardware and pad in place while tightening each joint. Note that adjustments may be affected by each other as gear teeth engage and require compensation from other joints before final tightening.

ATTENTION: It is crucial that gear teeth in all joints are properly aligned and engaged for a secure set up.

Gear Tooth Alignment

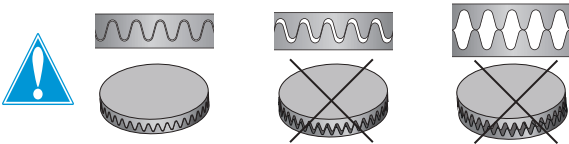

SET UP & ADJUSTMENTS (PT HARDWARE)

Max-8 Style PT Hardware (with 7" stem) shown. Other PT hardware styles will not have angle or as many depth adjustment points. Adjustments to be made simultaneously with pad positioning adjustments.

A = Angle/Lateral Offset

D = Depth

H = Height

Standard Taper Inserts

- 1 Loosen all hardware adjustment point screws allowing for full articulation of the head support to a desired position.
- 2 Hold hardware and pad in place while tightening each joint.

Tool-Less Wing Locks (not pictured)

- 1 Turn wing lock(s) counter-clockwise to loosen hardware adjustment points allowing for articulation.
- 2 Turn wing lock(s) clockwise to tighten.



FINISH

Locking the height adjustment collar on GT and PT hardware.
3" Stem does not have a height adjustment collar.

- 1 Finish setup by loosening set screw **D** in collar **A**.
- 2 Slide collar **A** on hardware stem **C** to meet the top of mounting bracket **B**.
- 3 Tighten set screw **D** in the collar with 2mm hex key until contact is made with the hardware stem. This allows for easy positioning of the hardware if it is removed and then replaced.

Note: Collar **A** is retained in a track in stem **C**. If the collar needs to be removed, remove the set screw **E** located in the track at the bottom of the stem with the 2mm allen wrench provided.

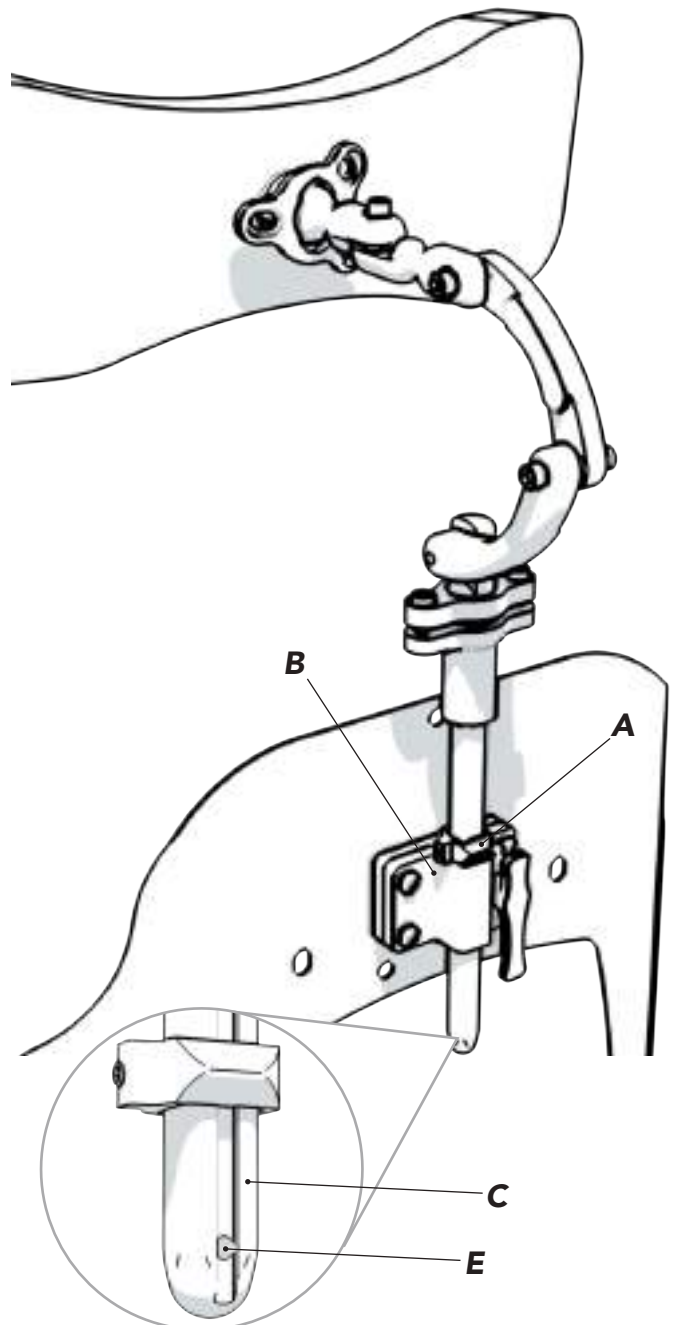
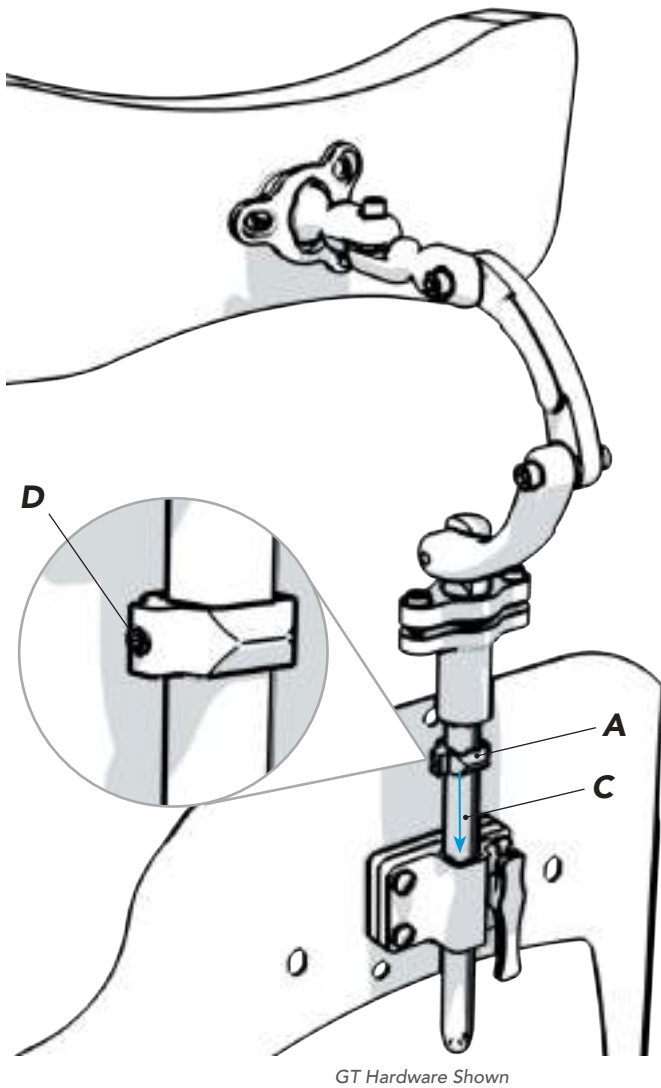

CLEANING

Frequent heat drying and bleaching naturally cause fabric break down.

Air drying and cleaning without bleach are recommended whenever possible to help extend the life of the cover.

SURFACE CLEANING COMFORT-TEK FABRIC ONLY*



Spray with common household or commercial antibacterial cleansers or disinfectants.



Wipe with damp, water-only cloth after disinfecting and let dry before use.

COMPLETE CLEANING (ALL FABRICS)

Remove cover from head support pad and hardware.

Machine wash cover using any common laundry detergents. Let dry completely before use.



Machine Wash any temperature
Maximum 66°C/150°F



Hand Wash when possible



Tumble Dry Low Temperature Only



Air Dry when possible



Do Not Steam Clean or Autoclave
Do Not Tumble Dry High Temperature



Do Not Iron



Do not wash or dry Stretch-Air™ and GlideWear® covers along with hook and loop fasteners or other materials that could snag the fabric.
Note: Doing so could pull at the fabrics causing changes in the appearance but not the effectiveness of the fabrics.

DISINFECTING (ALL FABRICS)

Remove cover from head support pad and hardware. Wash cover with water and bleach followed by thorough rinse.

Follow directions on bleach container. Let dry completely before use.



Machine Wash Maximum 66°C/150°F



Bleach

FOAM

Soiled foams should be replaced. Remove cover, dab foam with water-only cloth and let dry completely before replacing cover.



DO NOT submerge foam in any liquid, including water.



Dab with clean, damp, water-only cloth.



DO NOT use contaminated foam with multiple users.



Air Dry Only.

Foam should not be exposed to light for any extended period of time. Light will cause discoloration of the foam. This only effects the appearance of the foam, not the functional features. There is no need to attempt to "clean" discoloration caused by light exposure.

MAINTENANCE

INSPECTION

Inspect all head support components monthly.

Check and tighten all fasteners and adjustment points.

Inspect all materials for wear such as stretching, fraying, fractures, and bends. Some wear with regular use is expected. Signs of excessive wear to any component should be addressed by contacting your dealer or customer service for repair or replacement parts.

REUSE

You must re-fit the support to the new user or after extended periods of non-use by the same user. Follow the "Set up & Adjustments" procedure on Pages 16-20 to do so.

Before transferring to a new user, the product must be completely cleaned and disinfected as outlined on page 21.

STORAGE

Assembly or individual parts should not be stored in extreme hot or cold temperatures. Only store in a clean and dry place at room temperature.

Do not allow exposure to direct sunlight for prolonged periods of time. This could age the product more rapidly and decrease its effectiveness.

Do not store where there is risk of open flame or spark.

DISPOSAL

Please contact your local authorities for regulations on the proper disposal of your product and its components.



DO NOT incinerate as a means of disposal.

WARRANTY

This product is covered by the *Comfort Company Lifetime Guarantee*.



If a manufacturing defect should occur, the product will be replaced at no cost to the buyer. Register your product at www.comfortcompany.com/registration to activate Lifetime Guarantee.

If manufacturing defects should occur, discontinue use immediately.

Wear from regular use is not considered a manufacturing defect. Replacement parts are available by contacting Customer Service or your supplier, distributor, or retailer.

Any alterations made to the product or defects caused by irregular use voids the warranty. We can only guarantee that BodiLink® Head Support system will properly mount to the *Comfort Company* products listed in this manual. Modifications in attempt to interface with any other products voids warranty.

WARRANTY REPLACEMENT PROCEDURE

Warranty claims should be filed by the original purchaser. End-users will need to contact the DME Supplier, Distributor or Retailer from whom the product was purchased. In the event the original dealer is not available, any authorized *Comfort Company* DME supplier, distributor or retailer will provide assistance.

DME suppliers, distributors or retailers with warranty issues will need to contact Customer Service by phone or email and provide original purchase order number, sales order number, or invoice number whenever possible. A Return Merchandise Authorization (RMA) will be issued by Customer Service so a warranty replacement order or quote can be processed.

COMMENTS

If you would like to contact us with your comments or concerns, please visit our website www.comfortcompany.com or refer to the "Contact Information" section of this manual.

We invite you to leave testimonials of the product on our website on the individual product pages.

THIS PAGE INTENTIONALLY LEFT BLANK

© 2018 Permobil

Comfort Company®, BodiLink®, Compass®, Acta-Back®, Acta-Embrace®, Visco Back® and Radius Back® are registered trademarks of Comfort Company. Acta-Relief™, Comfort-Tek™, and Stretch-Air™ are trademarks of Comfort Company.

Permobil® is a registered trademark of Permobil, Inc.

Quantum® is a registered trademark of Pride Mobility Products Corporation.

GlideWear® is a registered trademark of Tamarack Habilitation Technologies, Inc.

Viscool® is a registered trademark of American Excelsior Company.



www.comfortcompany.com



Stay connected to related news and updates through these resources.

www.comfortcompany.com/stay_connected